

**NOTICE!!**

**These documents have been scanned!**

**Do not place un-scanned documents beneath this notice!**

**Do not remove this notice from this file!**

GPO Jacket No. 560-102  
Print Order 61540  
Rise Business Services, LLC  
Job=AZ15 5/15/2019



Box Number= AZ15052



Claim Begin-End: AMC413502-AMC413502

1 Initial Receipt



AZ15052-7

AMC413297-AMC418724

**United States Department of the Interior**  
**Bureau of Land Management**  
 LANDS/RECREATION & PLANNING  
 ONE N CENTRAL AVE  
 PHOENIX, AZ 85004 -2203  
 Phone: 602-417-9200

Receipt

No:

2500913

Transaction #: 2577986

**ENTERED INTO COMPUTER**

Date of Transaction: 01/19/2012

CUSTOMER:

JAN 30 2012 *JB*

SILVER NICKEL MINING CO  
 5822 W MICHELLE DR  
 GLENDALE, AZ 85308-1244 US

LINE #	QTY	DESCRIPTION	REMARKS	UNIT PRICE	TOTAL
1	1.00	LOCATABLE MINERALS / MINING CLAIMS- NEW, UNADJUD, ONE OR MORE AUTH NOS / NEW MINING CLAIM LOCATION FEE \$34 <b>CASES: AMC413502/\$34.00</b>		- n/a -	34.00
2	1.00	LOCATABLE MINERALS / MINING CLAIMS- NEW, UNADJUD, ONE OR MORE AUTH NOS / NEW MINING CLAIM MAINT FEE \$140 <b>CASES: AMC413502/\$140.00</b>		- n/a -	140.00
3	1.00	LOCATABLE MINERALS / MINING CLAIMS- NEW, UNADJUD, ONE OR MORE AUTH NOS / NEW MINING CLAIM PROCESSING FEE \$15 <b>CASES: AMC413502/\$15.00</b>		- n/a -	15.00
<b>TOTAL:</b>					<b>\$189.00</b>

## PAYMENT INFORMATION

1	AMOUNT:	189.00	POSTMARKED:	N/A
	TYPE:	CHECK	RECEIVED:	01/19/2012
	CHECK NO:	1040		
	NAME:	SILVER NICKEL MINING CO 5822 W MICHELLE DR GLENDALE AZ 85308-1244 US		

## REMARKS

This receipt was generated by the automated BLM Collections and Billing System and is a paper representation of a portion of the official electronic record contained therein.

**NOTICE!!**

**These documents have been scanned!**

**Do not place un-scanned documents beneath this notice!**

**Do not remove this notice from this file!**

GPO Jacket No. 560-102  
Print Order 61540  
Rise Business Services, LLC  
Job=AZ15 5/15/2019



Box Number= AZ15052



Claim Begin-End: AMC413502-AMC413502

2 Correspondence



AZ15052-7

AMC413297-AMC418724

NO  
DOCUMENTS  
FOUND

NO DOCUMENTS FOUND  
NO DOCUMENTS FOUND

**NOTICE!!**

**These documents have been scanned!**

**Do not place un-scanned documents beneath this notice!**

**Do not remove this notice from this file!**

GPO Jacket No. 560-102  
Print Order 61540  
Rise Business Services, LLC  
Job=AZ15 5/15/2019



Box Number= AZ15052



Claim Begin-End: AMC413502-AMC413502

3 Transfers



AZ15052-7

AMC413297-AMC418724

When recorded return to:  
Frederick C Bauman, Esq.  
6440 Sky Pointe Dr., Ste 140-149  
Las Vegas, NV 89131



RECEIVED  
CLERK OF SUPERIOR COURT  
2017 NOV -3 P 3:1  
PHOENIX, ARIZONA

**QUITCLAIM MINING DEED**  
(Exempt A.6)

This Mining Deed, dated as of September 24, 2017, made by **McIntyre Mines, LLC**, an Arizona limited liability company having an address of 3760 NW 183<sup>rd</sup> Ave., Portland, OR 97229 (the "Grantor") to **Silver Nickel Mining Company**, an Arizona corporation having an address of 5822 W. Michelle Dr., Glendale, AZ 85308 (the "Grantee");

**WITNESSETH:**

WHEREAS, Grantor is the owner of eight unpatented lode mining claims in the Tiger Mining District in Sections 26 and 35 of T10N, R1W, G&SRB&M, Yavapai County, Arizona (the "Claims"), to wit:

<u>CLAIM NAME</u>	<u>CLAIMANT'S NAME</u>	<u>AMC NUMBER</u>	<u>DATE LOCATED</u>	<u>RECORDING INFO</u>
Growler	Clark Copper Mines, LLC	413502	01/12/2012	Bk 4857 p 885
		Amended	09/04/2014	Fee20140040821
Savoy 1	Clark Copper Mines, LLC	429544	09/04/2014	Fee20140040822
Savoy 2	Clark Copper Mines, LLC	429545	09/04/2014	Fee20140040823
Savoy 14	Clark Copper Mines, LLC	429628	09/04/2014	Fee20140040824
Savoy 15	Clark Copper Mines, LLC	429629	09/04/2014	Fee20140040825
Savoy 16	Clark Copper Mines, LLC	429630	09/04/2014	Fee20140040826
Savoy 17	Clark Copper Mines, LLC	429631	09/04/2014	Fee20140040827
Savoy 18	Clark Copper Mines, LLC	429632	09/04/2014	Fee20140040828

WHEREAS, Grantor desires to convey the Claims to Grantee;

NOW, THEREFORE, in consideration of the sum of Ten Dollars (\$10) Dollars in hand paid to Grantor, receipt of which is hereby acknowledged, and for other good and sufficient consideration the receipt and sufficiency of which is hereby acknowledged, the parties hereto, intending to be legally bound hereby, agree as follows:

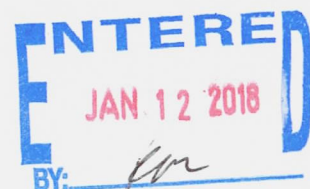

Grantor does by these presents hereby grant, bargain, sell, transfer, convey, set over and remise any and all of its interest in, to or under, the Claims unto Grantee, its successors and assigns, forever, including all mineral rights, water rights (if any), dumps and tailings located thereon.

TO HAVE AND TO HOLD the above described Claims unto Grantee, its successors and assigns, forever.

IN WITNESS WHEREOF, Grantor has caused this instrument to be executed and delivered as of the day and year first above written.

McINTYRE MINES, LLC , an  
Arizona limited liability company

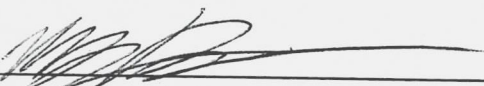
By   
Name: Morgan L. Bauman  
Title: Successor Trustee

RECEIVED  
PLM ATTORNEY OFFICE  
2017 NOV -3 PM 3:12  
PHOENIX, ARIZONA

STATE OF OREGON )

)ss.

COUNTY OF Washington

**ACKNOWLEDGMENT**

On this 2 day of October, 2017, before me, an undersigned Notary Public, personally appeared Morgan L. Bauman, known to me to be the individual who executed the foregoing instrument and acknowledged the same to be her free act and deed.

My Commission Expires 10/24/2020

*Cintia Zuniga*  
Notary Public

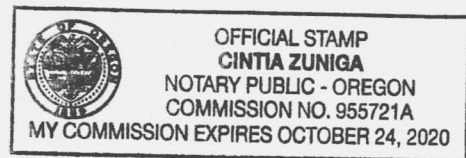

RECEIVED  
PLM ATTORNEY OFFICE  
2017 NOV -3 P 3:13  
PHOENIX, ARIZONA

SILVER NICKEL MINING CO  
2222 W. CLEARVIEW TRAIL  
ANTHEM, AZ 85086

PHOENIX AZ 852

02 NOV 2017 PM 10 L



Bureau of Land Management  
One N. Central Ave Ste 800  
Phoenix, AZ 85004-

RECEIVED  
BLM AZ STATE OFFICE  
2017 NOV -3 P 3:11  
PHOENIX, ARIZONA

85004-442700



SILVER NICKEL MINING CO  
2222 W. CLEARVIEW TRAIL  
ANTHEM, AZ 85086

PHOENIX AZ 852

02 NOV 2017 PM 10 L

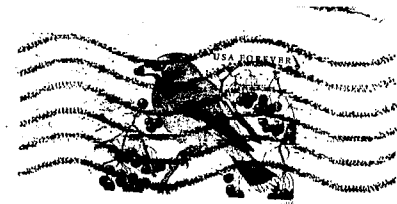

Bureau of Land Management  
One N. Central Ave Ste 800  
Phoenix, AZ 85004-

RECEIVED  
BLM AZ STATE OFFICE  
01 NOV - 3 PM 3:11  
PHOENIX, ARIZONA

85004-442700

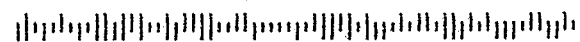

**United States Department of the Interior**  
**Bureau of Land Management**  
DIV OF LANDS, MINRLS & ENERGY  
ONE N CENTRAL AVE  
PHOENIX, AZ 85004 -4427  
Phone: 602-417-9200

Receipt

No: 4011803

<b>Transaction #:</b> 4122398	
<b>Date of Transaction:</b> 11/06/2017	
CUSTOMER:	
	FREDERICK C BAUMAN 6440 SKY POINTE DR STE 140-149 LAS VEGAS,NV 89131-4047 US

LINE #	QTY	DESCRIPTION	REMARKS	UNIT PRICE	TOTAL
1	1.00	LOCATABLE MINERALS / MINING CLAIMS- NOT NEW-UNADJUD,ONE AUTH NO. ONLY / MINING CLAIM MONEY RECEIVED CASES: AMC413502/\$70.00	TRF/7	- n/a -	70.00
TOTAL:					\$70.00

PAYMENT INFORMATION				
1	AMOUNT:	70.00	POSTMARKED:	N/A
	TYPE:	CHECK	RECEIVED:	11/03/2017
	CHECK NO:	1183		
	NAME:	SILVER NICKEL MINING CO 2222 W CLEARVIEW TRL ANTHEM AZ 85086 US		

REMARKS

This receipt was generated by the automated BLM Collections and Billing System and is a paper representation of a portion of the official electronic record contained therein.



# United States Department of the Interior

BUREAU OF LAND MANAGEMENT

Arizona State Office

One North Central Avenue, Suite 800

Phoenix, Arizona 85004-4427

[www.blm.gov/az/](http://www.blm.gov/az/)



In Reply Refer To:  
3800 (9200) RM  
AMC429623

DEC 20 2017

CERTIFIED MAIL - RETURN RECEIPT REQUESTED 7017 0190 0000 4056 9902

## NOTICE

SILVER NICKEL MINING CO  
5822 W MICHELLE DR  
GLENDALE, AZ 85308-1244

This Decision Affects Those Claims  
Shown in the Block Below.

AMC429632  
SAVOY 18

### Transfer(s) Not Processed

A conveyance document to transfer ownership of the mining claim(s) listed above was received by the Bureau of Land Management (BLM) Arizona State Office. The transfer(s) of ownership cannot be processed for the following reason(s):

An insufficient amount of money was received. The processing fee for a transfer of interest is \$10 per claim, per grantee. An additional fee of \$10 is required.

If appropriate, please submit a corrected conveyance document, required documents, or additional fees, within 30 days of your receipt of this notice. If the required information is not received within the 30-day timeframe, no further action will be taken, and the BLM will retain the non-refundable processing fees submitted.

If additional information is required, please contact RéAnn Myers at 602-417-9413. Please include your AMC serial number(s) on all correspondence.

Lucas Lucero

Deputy State Director

Lands, Minerals and Energy Division

# 4059769

RECEIVED  
BLM ARIZONA  
2018 JAN -4 P 1:00  
PHOENIX, ARIZONA

# **POOR QUALITY**

**The following pages are scanned at the best possible quality setting. The original pages are of poor quality and this is the best possible reproduction.**

United States Department of the Interior  
Bureau of Land Management  
DIV OF LANDS, MINRLS & ENERGY  
ONE N CENTRAL AVE  
PHOENIX, AZ 85004 -4427  
Phone: 602-417-9200

Receipt

No:

4011803

Transaction #: 4122398

Date of Transaction: 11/06/2017

CUSTOMER:

FREDERICK C BAUMAN  
6440 SKY POINTE DR STE 140-149  
LAS VEGAS, NV 89131-4047 US

LINE #	QTY	DESCRIPTION	REMARKS	UNIT PRICE	TOTAL
1	1.00	LOCATABLE MINERALS / MINING CLAIMS- NOT NEW-UNADJUD, ONE AUTH NO. ONLY / MINING CLAIM MONEY RECEIVED CASES: AMC413502/\$70.00	TRF/7	- n/a -	70.00
TOTAL:					\$70.00

PAYMENT INFORMATION			
1	AMOUNT:	70.00	POSTMARKED: N/A
	TYPE:	CHECK	RECEIVED: 11/03/2017
	CHECK NO:	1183	
	NAME:	SILVER NICKEL MINING CO 2222 W CLEARVIEW TRL ANTHEM AZ 85086 US	

REMARKS

This receipt was generated by the automated BLM Collections and Billing System and is a paper representation of a portion of the official electronic record contained therein.

RECEIVED  
BLM ARIZONA  
2018 JAN -4 P 1:07  
PHOENIX, ARIZONA

When recorded return to:  
Frederick C Bauman, Esq.  
6440 Sky Pointe Dr., Ste 140-149  
Las Vegas, NV 89131



RECEIVED  
CLIM AT STATE OFFICE  
2017 NOV - 3 P 3:11  
PHOENIX, ARIZONA

**QUITCLAIM MINING DEED**  
(Exempt A.6)

This Mining Deed, dated as of September 24, 2017, made by McIntyre Mines, LLC, an Arizona limited liability company having an address of 3760 NW 183<sup>rd</sup> Ave., Portland, OR 97229 (the "Grantor") to Silver Nickel Mining Company, an Arizona corporation having an address of 5822 W. Michelle Dr., Glendale, AZ 85308 (the "Grantee");

**WITNESSETH:**

WHEREAS, Grantor is the owner of eight unpatented lode mining claims in the Tiger Mining District in Sections 26 and 35 of T10N, R1W, G&SRB&M, Yavapai County, Arizona (the "Claims"), to wit:

<u>CLAIM NAME</u>	<u>CLAIMANT'S NAME</u>	<u>AMC NUMBER</u>	<u>DATE LOCATED</u>	<u>RECORDING INFO</u>
Growler	Clark Copper Mines, LLC	413502	01/12/2012	Bk 4857 p 885
Savoy 1	Clark Copper Mines, LLC	Amended 429544	09/04/2014	Fee20140040821
Savoy 2	Clark Copper Mines, LLC	429545	09/04/2014	Fee20140040822
Savoy 14	Clark Copper Mines, LLC	429628	09/04/2014	Fee20140040823
Savoy 15	Clark Copper Mines, LLC	429629	09/04/2014	Fee20140040824
Savoy 16	Clark Copper Mines, LLC	429630	09/04/2014	Fee20140040825
Savoy 17	Clark Copper Mines, LLC	429631	09/04/2014	Fee20140040826
Savoy 18	Clark Copper Mines, LLC	429632	09/04/2014	Fee20140040827
				Fee20140040828

WHEREAS, Grantor desires to convey the Claims to Grantee;

NOW, THEREFORE, in consideration of the sum of Ten Dollars (\$10) Dollars in hand paid to Grantor, receipt of which is hereby acknowledged, and for other good and sufficient consideration the receipt and sufficiency of which is hereby acknowledged, the parties hereto intending to be legally bound hereby, agree as follows:

RECEIVED  
CLIM AT STATE OFFICE  
2017 JAN - 4 P 1:07  
PHOENIX, ARIZONA

Grantor does by these presents hereby grant, bargain, sell, transfer, convey, set over and remise any and all of its interest in, to or under, the Claims unto Grantee, its successors and assigns, forever, including all mineral rights, water rights (if any), dumps and tailings located thereon.

TO HAVE AND TO HOLD the above described Claims unto Grantee, its successors and assigns, forever.

IN WITNESS WHEREOF, Grantor has caused this instrument to be executed and delivered as of the day and year first above written.

McINTYRE MINES, LLC, an  
Arizona limited liability company

By [Signature]  
Name: Morgan L. Bauman  
Title: Successor Trustee

RECEIVED  
PLM AZ STATE OFFICE  
2018 JAN -4 P 1:07  
PHOENIX, ARIZONA

RECEIVED  
PLM AZ STATE OFFICE  
2017 NOV -3 P 3:12  
PHOENIX, ARIZONA

STATE OF OREGON )

)ss.

COUNTY OF Washington

# ACKNOWLEDGMENT

On this 2 day of October, 2017, before me, an undersigned Notary Public, personally appeared Morgan L. Bauman, known to me to be the individual who executed the foregoing instrument and acknowledged the same to be her free act and deed.

My Commission Expires 10/24/2020

*Cintia Zuniga*  
Notary Public

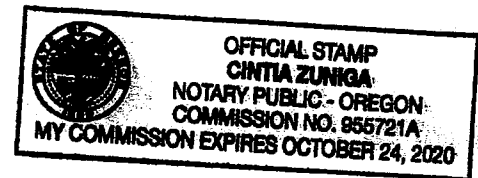

RECEIVED  
CLM AV STATE OFFICE  
2018 JAN - 4 P 1:07  
PHOENIX, ARIZONA

RECEIVED  
CLM AV STATE OFFICE  
2017 NOV - 3 P 3:12  
PHOENIX, ARIZONA

**United States Department of the Interior**  
**Bureau of Land Management**  
DIV OF LANDS, MINRLS & ENERGY  
ONE N CENTRAL AVE  
PHOENIX, AZ 85004 -4427  
Phone: 602-417-9200

Receipt

No: 4059769

<b>Transaction #:</b> 4171372	
<b>Date of Transaction:</b> 01/04/2018	
<b>CUSTOMER:</b>	
	SILVER NICKEL MINING CO 5822 W MICHELLE DR GLENDALE, AZ 85308-1244 US

LINE #	QTY	DESCRIPTION	REMARKS	UNIT PRICE	TOTAL
1	1.00	LOCATABLE MINERALS / MINING CLAIMS- NOT NEW-UNADJUD, ONE AUTH NO. ONLY / MINING CLAIM MONEY RECEIVED <b>CASES:</b> AMC429632/\$10.00	TRF/1	- n/a -	10.00
<b>TOTAL:</b>					<b>\$10.00</b>

PAYMENT INFORMATION				
1	AMOUNT:	10.00	POSTMARKED:	N/A
	TYPE:	CHECK	RECEIVED:	01/04/2018
	CHECK NO:	1194		
	NAME:	SILVER NICKEL MINING CO 2222 W CLEARVIEW TRL ANTHEM AZ 85086 US		

REMARKS
<i>Envelope is with mining claim - full</i>

This receipt was generated by the automated BLM Collections and Billing System and is a paper representation of a portion of the official electronic record contained therein.

When recorded return to:  
Frederick C Bauman, Esq.  
6440 Sky Pointe Dr., Ste 140-149  
Las Vegas, NV 89131



Amc413502

429544

429628

### QUITCLAIM MINING DEED

This Mining Deed, dated as of May 30, 2017, made by **Clark Copper Mines, LLC**, an Arizona limited liability company with an address of 6440 Sky Pointe Dr., Ste 140-412, Las Vegas, NV 89131 (the "Grantor") to **McIntyre Mines, LLC**, an Arizona limited liability company having an address of 3760 NW 183<sup>rd</sup> Ave., Portland, OR 97229 (the "Grantee");

#### WITNESSETH:

WHEREAS, Grantor is the owner of eight unpatented lode mining claims in the Tiger Mining District in Sections 26 and 35 of T10N, R1W, G&SRB&M, Yavapai County, Arizona (the "Claims"), to wit:

<u>CLAIM NAME</u>	<u>CLAIMANT'S NAME</u>	<u>AMC NUMBER</u>	<u>DATE LOCATED</u>	<u>RECORDING INFO</u>
Growler	Clark Copper Mines, LLC	413502	01/12/2012	Bk 4857 p 885
		Amended	09/04/2014	Fee20140040821
Savoy 1	Clark Copper Mines, LLC	429544	09/04/2014	Fee20140040822
Savoy 2	Clark Copper Mines, LLC	429545	09/04/2014	Fee20140040823
Savoy 14	Clark Copper Mines, LLC	429628	09/04/2014	Fee20140040824
Savoy 15	Clark Copper Mines, LLC	429629	09/04/2014	Fee20140040825
Savoy 16	Clark Copper Mines, LLC	429630	09/04/2014	Fee20140040826
Savoy 17	Clark Copper Mines, LLC	429631	09/04/2014	Fee20140040827
Savoy 18	Clark Copper Mines, LLC	429632	09/04/2014	Fee20140040828

WHEREAS, Grantor desires to convey the Claims to Grantee;

NOW, THEREFORE, in consideration of the sum of Ten Dollars (\$10) Dollars in hand paid to Grantor, receipt of which is hereby acknowledged, and for other good and sufficient consideration the receipt and sufficiency of which is hereby acknowledged, the parties hereto, intending to be legally bound hereby, agree as follows:



# 3893487

RECEIVED  
JUL 13 2017  
P 3:13  
YAVAPAI COUNTY ARIZONA

Grantor does by these presents hereby grant, bargain, sell, transfer, convey, set over and remise any and all of its interest in, to or under, the Claims unto Grantee, its successors and assigns, forever, including all mineral rights, water rights (if any), dumps and tailings located thereon.

TO HAVE AND TO HOLD the above described Claims unto Grantee, its successors and assigns, forever.

IN WITNESS WHEREOF, Grantor has caused this instrument to be executed and delivered as of the day and year first above written.

THE GRANTOR:

CLARK COPPER MINES, LLC, an Arizona limited liability company

By its Manager:

SEARCHLIGHT STRATEGIC RESOURCES, LLC, an Arizona limited liability company

By its Manager:

McINTYRE & BAUMAN GROUP, LLC, an Arizona limited liability company

By its Manager:

SEARCHLIGHT EXPLORATION, LLC, an Arizona limited liability company

By   
Name: Frederick C. Bauman \_\_\_\_\_  
Title: Manager \_\_\_\_\_

RECEIVED  
2011 JUL 17 P 3:13  
JOSEPH, ARIZONA

STATE OF NEVADA       )  
                                  )ss.  
COUNTY OF CLARK       )

**ACKNOWLEDGMENT**

On this 31<sup>st</sup> day of May, 2017, before me, an undersigned Notary Public, personally appeared Frederick C. Bauman, known to me to be the individual who executed the foregoing instrument and acknowledged the same to be her free act and deed.

My Commission Expires 09-17-2018

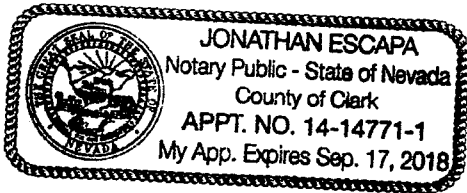

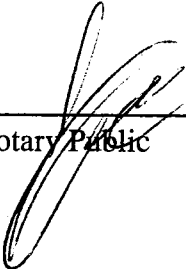
  
\_\_\_\_\_  
Notary Public

RECEIVED  
CLM & ASSOCIATES  
2017 JUL 17 P 3:13  
PHOENIX, ARIZONA

**BAUMAN & ASSOCIATES LAW FIRM**

**FREDERICK C. BAUMAN**

**Attorney-at-Law**

**Nevada Bar No. 8370**

**6440 Sky Pointe Dr., Ste 140-149**

**Las Vegas, NV 89131 U.S.A.**

**[www.lawbauman.com](http://www.lawbauman.com)**

**(702) 533-8372**

**(800) 991-8697**

**[fred@lawbauman.com](mailto:fred@lawbauman.com)**

July 10, 2017

United States Bureau of Land Management  
Arizona State Office  
1 N Central Ave, Ste 800  
Phoenix, AZ 85004  
Attn: Mining Claims

RECEIVED  
BLM ARIZONA OFFICE  
2017 JUL 17 P 3:12  
PHOENIX, ARIZONA

Re: Transfer of 8 unpatented mining claims; filing of Small Miner Waiver by Claimant

Ladies and Gentlemen:

Eight (8) unpatented mining claims have been deeded by Clark Copper Mines, LLC (which is not a small miner) to McIntyre Mines, LLC, which is a small miner. Morgan Bauman is the Manager and sole owner of McIntyre Mines, LLC. She is also the owner of four (4) patented mining claims that adjoin the eight (8) deeded unpatented claims.

A copy of the recorded deed is enclosed, together with a check for \$80 to pay the claim transfer fee for 8 claims @ \$10 per claim.

Also enclosed is a Maintenance Fee Waiver Form signed by Morgan Bauman as Manager of McIntyre Mines, LLC. While Morgan Bauman is my daughter, she is over the age of 21 and resides in Oregon. Therefore, Morgan and I are not deemed to be related parties under BLM regulations.

Please do not hesitate to call if you have any questions (702) 533-8372.

Sincerely yours,

BAUMAN & ASSOCIATES LAW FIRM

By   
Frederick C. Bauman

Bauman + Assoc.  
6440 Sky Pointe Dr.,  
Ste 140-149  
Las Vegas, NV 89131

LAS VEGAS NV 890

12 JUL 2017 PM 3 1



United States Bureau of Land Management  
Arizona State Office  
1 N. Central Ave, Ste 800  
Phoenix, AZ

Attn: Mining Claims

8500434427 C041

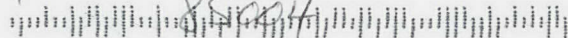

PHOENIX, ARIZONA

2017 JUL 17 P 3:12

RECEIVED  
BLM AZ STATE OFFICE

Bauman + Assoc.  
6440 Sky Pointe Dr.,  
Ste 140-149  
Las Vegas, NV 89131

LAS VEGAS NV 890

12 JUL 2017 PM 3 L

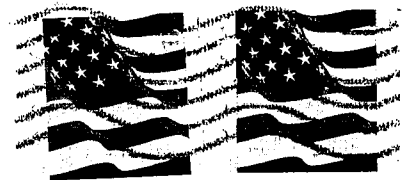

United States Bureau of Land Management  
Arizona State Office  
1 N. Central Ave, Ste 800  
Phoenix, AZ

Attn: Mining Claims

8500434427 0041



PHOENIX, ARIZONA

2017 JUL 17 P 3:12

RECEIVED  
BUREAU OF LAND MANAGEMENT

**United States Department of the Interior**  
**Bureau of Land Management**  
DIV OF LANDS, MINRLS & ENERGY  
ONE N CENTRAL AVE  
PHOENIX, AZ 85004 -4427  
Phone: 602-417-9200

Receipt

No: 3893687

**Transaction #:** 4002948**Date of Transaction:** 07/18/2017

CUSTOMER:

FREDERICK C BAUMAN  
6440 SKY POINTE DR STE 140-149  
LAS VEGAS,NV 89131-4047 US

LINE #	QTY	DESCRIPTION	REMARKS	UNIT PRICE	TOTAL
1	1.00	LOCATABLE MINERALS / MINING CLAIMS- NOT NEW-UNADJUD,ONE AUTH NO. ONLY / MINING CLAIM MONEY RECEIVED CASES: AMC413502/\$80.00	TRF/8 WAV 2017/10	- n/a -	80.00
<b>TOTAL:</b>					<b>\$80.00</b>

PAYMENT INFORMATION					
1	AMOUNT:	80.00		POSTMARKED:	07/12/2017
	TYPE:	CHECK		RECEIVED:	07/17/2017
	CHECK NO:	1185			
	NAME:	BAUMANN, FREDERICK C 6440 SKY POINTE DR STE 140-149 LAS VEGAS NV 89131-4047 US			

REMARKS

This receipt was generated by the automated BLM Collections and Billing System and is a paper representation of a portion of the official electronic record contained therein.

When recorded return to:  
Frederick C. Bauman  
9212 Empire Rock Street  
Las Vegas, NV 89143



Amc 413502  
Amc 396788

**QUITCLAIM MINING DEED**  
(Exempt A. R. S. 11-1134(A)(4))

This Quitclaim Mining Deed, dated as of February 22, 2012, made by **Silver Nickel Mining Co.**, an Arizona corporation having an address of 5822 W. Michelle Drive., Glendale, AZ 85308 (referred to herein as "Grantor") to **Clark Copper Mines, LLC.**, an Arizona limited liability company with a present address of 9212 Empire Rock Street, Las Vegas, NV 89143 (referred to herein as "Grantee");

WITNESSETH;

WHEREAS, Grantor is the owner of that certain unpatented mining claim located in the Tiger Mining Districts, Yavapai County, Arizona (the "Claim"), to wit:

The Growler unpatented lode mining claim, located in the Tiger Mining District, Yavapai County, Arizona, recorded with the Yavapai County Recorder at Book 4857, page 885 and with the Arizona State Office of the United States Bureau of Land Management as **AMC413502.**

WHEREAS, Grantor desires to convey all of his right, title and interest in and to the Claim to Grantee, subject to any existing lease of the Claims to the lessee thereunder;

NOW, THEREFORE, in consideration of the sum of Ten Dollars (\$10) Dollars in hand paid to Grantor, receipt of which is hereby acknowledged, and for other good and sufficient consideration the receipt and sufficiency of which is hereby acknowledged, the parties hereto, intending to be legally bound hereby, agree as follows:

Grantor does by these presents hereby grant, bargain, sell, transfer, convey, set over, remise, release and quitclaim unto Grantee and its successors and assigns, forever, all of Grantor's right, title, interest and estate in, to and under the Claim, including to all surface and mineral rights, water rights, dumps and tailings located thereon and all of Grantor's rights in, to and under any lease of the Claim.

TO HAVE AND TO HOLD the above described Claim unto the Grantee, its successors and assigns, forever.

IN WITNESS WHEREOF, Grantor has caused this instrument to be executed and delivered as of the day and year first above written.

NO. OF CLAIMS 1  
AMOUNT \$10.00  
RECEIPT NO. 2535586  
INIT. CAH

\*\* RLM-ASO\*\*

ENTERED INTO COMPUTER

4/10/12 AT

RECEIVED  
BLM / STATE OFFICE  
2012 MAR 19 12 15



THE GRANTOR  
SILVER NICKEL MINING CO.,  
An Arizona corporation

By John B. Rothermel, President  
John B. Rothermel, President

STATE OF ARIZONA )

)ss.

**ACKNOWLEDGMENT**

COUNTY OF MARICOPA)

On this 23 day of February, 2012, before me, the undersigned Notary Public, personally appeared John B. Rothermel, known to me to be the individual who executed the foregoing instrument and acknowledged the same to be his free act and deed.

My Commission Expires 2/13/15

[Signature]  
Notary Public

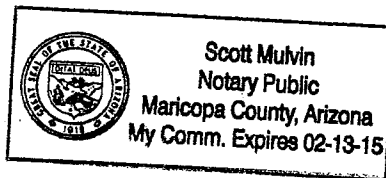

FILED  
2012 FEB 12 PM 2:16  
MARICOPA COUNTY, ARIZONA

When recorded return to:  
Frederick C. Bauman  
9212 Empire Rock Street  
Las Vegas, NV 89143



**QUITCLAIM MINING DEED**  
(Exempt A. R. S. 11-1134(A)(6))

This Quitclaim Mining Deed, dated as of February 23, 2012, made by **Fred M Rothermel**, a married man as his sole and separate property, having an address of 11041 W. Coggins Drive, Sun City, AZ 85351 (referred to herein as "Grantor") to **Clark Copper Mines, LLC.**, an Arizona limited liability company with a present address of 9212 Empire Rock Street, Las Vegas, NV 89143 (referred to herein as "Grantee");

WITNESSETH;

WHEREAS, Grantor is the owner of a 50% undivided interest in those certain unpatented lode mining claims located in the Tiger Mining Districts, Yavapai County, Arizona (the "Claims"), to wit:

Claim	AMC#	Recording Info	Township / Range / Section	Date Located
Calumet Prescott	396788	Bk 4675 p 875	T10N / R10W / Sec 26, 35	5/08/2009
Rapid Transit	396789	Bk 4675 p 874	T10N / R10W / Sec 26	5/08/2009
Rapid Transit East	396790	Bk 4675 p 873	T10N / R10W / Sec 26	5/08/2009

WHEREAS, Grantor desires to convey all of his right, title and interest in and to the Claims to Grantee, subject to any existing lease of the Claims to the lessee thereunder;

NOW, THEREFORE, in consideration of the sum of Ten Dollars (\$10) Dollars in hand paid to Grantor, receipt of which is hereby acknowledged, and for other good and sufficient consideration the receipt and sufficiency of which is hereby acknowledged, the parties hereto, intending to be legally bound hereby, agree as follows:

Grantor does by these presents hereby grant, bargain, sell, transfer, convey, set over, remise, release and quitclaim unto Grantee and its successors and assigns, forever, all of Grantor's right, title, interest and estate in, to and under the Claims, including to all surface and mineral rights, water rights, dumps and tailings located thereon and all of Grantor's rights in, to and under any lease of the Claims.

TO HAVE AND TO HOLD the above described Claims unto the Grantee, its successors and assigns, forever.

NO. OF CLAIMS 3  
AMOUNT \$30.00  
RECEIPT NO. 2535586  
INIT. CLM

\*\* BLM-ASO\*\*

ENTERED INTO COMPUTER

4/10/12 AT

RECEIVED  
BLM AZ STATE OFFICE  
2012 MAR 19 PM 2:16

2  
FEE  
\$4  
\$5  
\$1  
\$10  
\$

IN WITNESS WHEREOF, Grantor has caused this instrument to be executed and delivered as of the day and year first above written.

THE GRANTOR

By Fred M Rothermel  
Fred M. Rothermel

STATE OF ARIZONA )

)ss.

ACKNOWLEDGMENT

COUNTY OF MARICOPA)

On this 24 day of February, 2012, before me, the undersigned Notary Public, personally appeared Fred M. Rothermel, known to me to be the individual who executed the foregoing instrument and acknowledged the same to be his free act and deed.

My Commission Expires 5/26/13

Robin F. Marichalar  
Notary Public

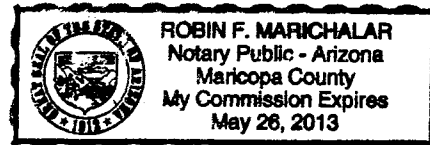

RECEIVED  
2012 FEB 19 PM 2:16  
MARICOPA COUNTY, ARIZONA

Baum  
9212 Empire Rock St  
Las Vegas, NV 89143

LAS VEGAS NV 890  
16 MAR 2012 PM 3 1



USDOJ/BLM  
1 N. Central Ave, Suite 800  
Phoenix, AZ

RECEIVED  
BLM AZ STATE OFFICE  
2012 MAR 19 PM 2:15  
PHOENIX, ARIZONA

Attn: Mining Claims

85004

United States Department of the Interior  
Bureau of Land Management  
LANDS/RECREATION & PLANNING  
ONE N CENTRAL AVE  
PHOENIX, AZ 85004 -2203  
Phone: 602-417-9200

Receipt

No: 2535586

Transaction #: 2614066

Date of Transaction: 03/20/2012

CUSTOMER:

FREDERICK C BAUMAN  
9212 EMPIRE ROCK ST  
LAS VEGAS,NV 89143-1372 US

LINE #	QTY	DESCRIPTION	REMARKS	UNIT PRICE	TOTAL
1	1.00	LOCATABLE MINERALS / MINING CLAIMS-NOT NEW-UNADJUD,ONE AUTH NO. ONLY / MINING CLAIM MONEY RECEIVED CASES: AMC413502/\$40.00	QCD (4)	- n/a -	40.00
TOTAL:					\$40.00

## PAYMENT INFORMATION

1	AMOUNT:	40.00	POSTMARKED:	03/16/2012
	TYPE:	CHECK	RECEIVED:	03/20/2012
	CHECK NO:	5910		
	NAME:	BAUMAN, FREDERICK C 9212 EMPIRE ROCK ST LAS VEGAS NV 89143-1372 US		

## REMARKS

This receipt was generated by the automated BLM Collections and Billing System and is a paper representation of a portion of the official electronic record contained therein.

**NOTICE!!**

**These documents have been scanned!**

**Do not place un-scanned documents beneath this notice!**

**Do not remove this notice from this file!**

GPO Jacket No. 560-102  
Print Order 61540  
Rise Business Services, LLC  
Job=AZ15 5/15/2019



Box Number= AZ15052



Claim Begin-End: AMC413502-AMC413502

4 Miscellaneous



AZ15052-7

AMC413297-AMC418724

**United States Department of the Interior**  
**Bureau of Land Management**  
 BUSINESS & SUPPORT SVCS DIV  
 ONE N CENTRAL AVE SUITE 800  
 PHOENIX, AZ 85004 -4427  
 Phone: 602-417-9200

Receipt

No: 3953860

Amc413502

429544

429628

<b>Transaction #:</b> 4063607	
<b>Date of Transaction:</b> 08/23/2017	
<b>CUSTOMER:</b>	
	F N HAWKINS 2222 W CLEARVIEW TRAIL ANTHEM, AZ 85086 US

LINE #	QTY	DESCRIPTION	REMARKS	UNIT PRICE	TOTAL
1	1.00	LOCATABLE MINERALS / MINING CLAIMS- NOT NEW-UNADJUD, ONE AUTH NO. ONLY / MINING CLAIM MONEY RECEIVED CASES: AMC429545/\$1240.00		- n/a -	1240.00
<b>TOTAL:</b>					<b>\$1,240.00</b>

PAYMENT INFORMATION			
NOTE: Items will appear on credit card statement as "BLM O Mining Claim".			
1	AMOUNT:	1240.00	POSTMARKED: N/A
	TYPE:	CREDIT CARD	RECEIVED: 08/23/2017
	NAME:	F N HAWKINS 2222 W CLEARVIEW TRAIL ANTHEM AZ 85086 US	
	CARD NO:	XXXXXXXXXXXX0411	AUTH CODE: 02326P
	NAME ON CARD:	F N HAWKINS	
	EXPIRES:	05/2020	
	SIGNATURE:		

REMARKS

This receipt was generated by the automated BLM Collections and Billing System and is a paper representation of a portion of the official electronic record contained therein.

REFUNDS FOR DUPLICATE PAYMENT OF  
 2018 MAINTENANCE FEES ON  
 Amc 413502, Amc 429544, Amc 429545,  
 Amc 429628 - Amc 429632.  
 REFUND PROCESSED 8/23/2017 PM

**NOTICE!!**

**These documents have been scanned!**

**Do not place un-scanned documents beneath this notice!**

**Do not remove this notice from this file!**

GPO Jacket No. 560-102  
Print Order 61540  
Rise Business Services, LLC  
Job=AZ15 5/15/2019



Box Number= AZ15052



Claim Begin-End: AMC413502-AMC413502

5 Annual Filings



AZ15052-7

AMC413297-AMC418724

DEPARTMENT OF THE INTERIOR  
BUREAU OF LAND MANAGEMENT  
MINING CLAIMS

Run Date/Time: 8/8/2019

MC Maintenance Fees Paid Through the BLM Pay Portal  
(by Date Paid)

Page 33 Of 189

**CBS Receipt: 4522564**

Printed For Lead File # AMC413502

Agency Tracking ID: 1564706945

Assessment Year: 2020

Paid On: 8/2/2019

Number of BLM Serial Nr: 73

Total Amount Paid: \$12,045.00

Claim Name	BLM Serial No	Lead File No	Amount Paid
JUNCTION	AMC386588	AMC386588	\$165.00
UNION	AMC386590	AMC386588	\$165.00
GENERAL NO 149	AMC386592	AMC386592	\$165.00
RARE METALS #2	AMC399138	AMC399138	\$165.00
TWIN PEAKS #1	AMC401583	AMC401577	\$165.00
TWIN PEAKS #2	AMC401584	AMC401577	\$165.00
TWIN PEAKS #3	AMC401585	AMC401577	\$165.00
NORIEGA	AMC401586	AMC401577	\$165.00
BLACK WARRIOR #1	AMC406423	AMC406423	\$165.00
BLACK WARRIOR #4	AMC406426	AMC406423	\$165.00
TWIN PEAKS #7	AMC407554	AMC407551	\$165.00
GROWLER LODE	AMC413502	AMC413502	\$165.00
TROY RANCH 1	AMC421117	AMC421117	\$165.00
TROY RANCH	AMC421118	AMC421117	\$165.00
TROY 16	AMC422940	AMC422940	\$165.00
TROY 17	AMC422941	AMC422940	\$165.00
TROY 18	AMC422942	AMC422940	\$165.00
TROY 19	AMC422943	AMC422940	\$165.00
TROY 20	AMC422944	AMC422940	\$165.00
TROY 21	AMC422945	AMC422940	\$165.00
TROY 22	AMC422946	AMC422940	\$165.00
TROY 32A	AMC422947	AMC422940	\$165.00
TROY 35	AMC423024	AMC423024	\$165.00
TROY 36	AMC423025	AMC423024	\$165.00

NO WARRANTY IS MADE BY BLM FOR USE OF THE DATA FOR PURPOSES NOT INTENDED BY BLM

**DEPARTMENT OF THE INTERIOR  
BUREAU OF LAND MANAGEMENT  
MINING CLAIMS**

Run Date/Time: 8/8/2019

**MC Maintenance Fees Paid Through the BLM Pay Portal  
(by Date Paid)**

Page 34 Of 189

TROY 37	AMC423026	AMC423024	\$165.00
TROY 38	AMC423027	AMC423024	\$165.00
TROY 39	AMC423028	AMC423024	\$165.00
TROY 40	AMC423029	AMC423024	\$165.00
BLACK WARRIOR EXT	AMC425060	AMC425060	\$165.00
CRITIC NO 1	AMC426096	AMC426096	\$165.00
CRITIC NO 2	AMC426097	AMC426096	\$165.00
COPPER HILLS	AMC426240	AMC426240	\$165.00
SAVOY 1	AMC429544	AMC429544	\$165.00
SAVOY 2	AMC429545	AMC429544	\$165.00
SAVOY 14	AMC429628	AMC429628	\$165.00
SAVOY 15	AMC429629	AMC429628	\$165.00
SAVOY 16	AMC429630	AMC429628	\$165.00
SAVOY 17	AMC429631	AMC429628	\$165.00
SAVOY 18	AMC429632	AMC429628	\$165.00
SILVER BONANZA	AMC433778	AMC433778	\$165.00
SILVER RIDGE	AMC434006	AMC434006	\$165.00
SILVER RIDGE NO 1	AMC434007	AMC434006	\$165.00
SILVER RIDGE NO 2	AMC434008	AMC434006	\$165.00
NORTH TIGER NO 1	AMC438557	AMC438557	\$165.00
STANDARD-BULL RUN	AMC438785	AMC438785	\$165.00
SUE	AMC440267	AMC440267	\$165.00
NORTH COLOSSAL	AMC440420	AMC440420	\$165.00
TUSCUMBIA	AMC440546	AMC440526	\$165.00
COMPENSATION NO 2	AMC441152	AMC441152	\$165.00
BOSTON	AMC441241	AMC441241	\$165.00
CLEVELAND	AMC441242	AMC441241	\$165.00
COMPENSATION #3	AMC441243	AMC441241	\$165.00
COMPENSATION #4	AMC441244	AMC441241	\$165.00
BENTON GEN NO 16	AMC441664	AMC441664	\$165.00
GREY EAGLE EXT SOUTH	AMC448614	AMC448614	\$165.00
PF 18	AMC448714	AMC448714	\$165.00
PF 19	AMC448715	AMC448714	\$165.00
PF 20	AMC448716	AMC448714	\$165.00
PF 21	AMC448717	AMC448714	\$165.00

NO WARRANTY IS MADE BY BLM FOR USE OF THE DATA FOR PURPOSES NOT INTENDED BY BLM

**DEPARTMENT OF THE INTERIOR  
BUREAU OF LAND MANAGEMENT  
MINING CLAIMS**

Run Date/Time: 8/8/2019

**MC Maintenance Fees Paid Through the BLM Pay Portal  
(by Date Paid)**

Page 35 Of 189

PF 22	AMC448718	AMC448714	\$165.00
PF 28	AMC448719	AMC448714	\$165.00
PF 29	AMC448720	AMC448714	\$165.00
PF 30	AMC448721	AMC448714	\$165.00
OUTPOST 33	AMC449379	AMC449379	\$165.00
OUTPOST 34	AMC449380	AMC449379	\$165.00
OUTPOST 42	AMC449381	AMC449379	\$165.00
OUTPOST 43	AMC449382	AMC449379	\$165.00
OUTPOST 53	AMC449383	AMC449379	\$165.00
OUTPOST 54	AMC449384	AMC449379	\$165.00
RIDGETOP LODE	AMC450151	AMC450151	\$165.00
RAPID TRANSIT 1853	AMC452803	AMC452803	\$165.00
S B NO 1	AMC454198	AMC454198	\$165.00
S B NO 2	AMC454199	AMC454198	\$165.00

**United States Department of the Interior**  
**Bureau of Land Management**  
 BUSINESS & SUPPORT SVCS DIV  
 ONE N CENTRAL AVE SUITE 800  
 PHOENIX, AZ 85004 -4427  
 Phone: 602-417-9200

Receipt

No:

4522564

**Transaction #:** 4643232**Date of Transaction:** 08/01/2019**CUSTOMER:**

FRANK N. HAWKINS  
 2222 W. CLEARVIEW TRL  
 ANTHEM, AZ 85086 US

LINE #	QTY	DESCRIPTION	REMARKS	UNIT PRICE	TOTAL
1	1.00	LOCATABLE MINERALS / MINING CLAIMS- NOT NEW-UNADJUD, ONE AUTH NO. ONLY / MINING CLAIM MONEY RECEIVED <b>CASES: AMC399138/\$12045.00</b>		- n/a -	12045.00
<b>TOTAL:</b>					<b>\$12,045.00</b>

**PAYMENT INFORMATION**

NOTE: Items will appear on credit card statement as "BLM O Mining Claim".

1	AMOUNT:	12045.00	POSTMARKED:	N/A
	TYPE:	CREDIT CARD	RECEIVED:	08/01/2019
	NAME:	FRANK N. HAWKINS 2222 W. CLEARVIEW TRL ANTHEM AZ 85086 US		
	CARD NO:	XXXXXXXXXXXX2060	AUTH CODE:	001518
	NAME ON CARD:	FRANK N. HAWKINS		
	SIGNATURE:	INTERNET		

**REMARKS**

This receipt was generated by the automated BLM Collections and Billing System and is a paper representation of a portion of the official electronic record contained therein.

DEPARTMENT OF THE INTERIOR  
BUREAU OF LAND MANAGEMENT  
MINING CLAIMS

Run Date/Time: 8/20/2018

MC Maintenance Fees Paid Through the BLM Pay Portal  
(by Date Paid)

Page 80 Of 316

**CBS Receipt: 4232593**

Printed For Lead File # **AMC413502**

Agency Tracking ID: 1533947947

Assessment Year: 2019

Paid On: 8/11/2018

Number of BLM Serial Nr: 62

Total Amount Paid: \$9,610.00

Claim Name	BLM Serial No	Lead File No	Amount Paid
JUNCTION	AMC386588	AMC386588	\$155.00
UNION	AMC386590	AMC386588	\$155.00
GENERAL NO 149	AMC386592	AMC386592	\$155.00
RARE METALS #2	AMC399138	AMC399138	\$155.00
TWIN PEAKS #1	AMC401583	AMC401577	\$155.00
TWIN PEAKS #2	AMC401584	AMC401577	\$155.00
TWIN PEAKS #3	AMC401585	AMC401577	\$155.00
NORIEGA	AMC401586	AMC401577	\$155.00
BLACK WARRIOR #1	AMC406423	AMC406423	\$155.00
BLACK WARRIOR #4	AMC406426	AMC406423	\$155.00
TWIN PEAKS #7	AMC407554	AMC407551	\$155.00
GROWLER LODGE	AMC413502	AMC413502	\$155.00
TROY RANCH 1	AMC421117	AMC421117	\$155.00
TROY RANCH	AMC421118	AMC421117	\$155.00
TROY 16	AMC422940	AMC422940	\$155.00
TROY 17	AMC422941	AMC422940	\$155.00
TROY 18	AMC422942	AMC422940	\$155.00
TROY 19	AMC422943	AMC422940	\$155.00
TROY 20	AMC422944	AMC422940	\$155.00
TROY 21	AMC422945	AMC422940	\$155.00
TROY 22	AMC422946	AMC422940	\$155.00
TROY 32A	AMC422947	AMC422940	\$155.00
TROY 35	AMC423024	AMC423024	\$155.00
TROY 36	AMC423025	AMC423024	\$155.00

NO WARRANTY IS MADE BY BLM FOR USE OF THE DATA FOR PURPOSES NOT INTENDED BY BLM

**DEPARTMENT OF THE INTERIOR  
BUREAU OF LAND MANAGEMENT  
MINING CLAIMS**

Run Date/Time: 8/20/2018

**MC Maintenance Fees Paid Through the BLM Pay Portal  
(by Date Paid)**

Page 81 Of 316

TROY 37	AMC423026	AMC423024	\$155.00
TROY 38	AMC423027	AMC423024	\$155.00
TROY 39	AMC423028	AMC423024	\$155.00
TROY 40	AMC423029	AMC423024	\$155.00
BLACK WARRIOR EXT	AMC425060	AMC425060	\$155.00
CRITIC NO 1	AMC426096	AMC426096	\$155.00
CRITIC NO 2	AMC426097	AMC426096	\$155.00
COPPER HILLS	AMC426240	AMC426240	\$155.00
SAVOY 1	AMC429544	AMC429544	\$155.00
SAVOY 2	AMC429545	AMC429544	\$155.00
SAVOY 14	AMC429628	AMC429628	\$155.00
SAVOY 15	AMC429629	AMC429628	\$155.00
SAVOY 16	AMC429630	AMC429628	\$155.00
SAVOY 17	AMC429631	AMC429628	\$155.00
SAVOY 18	AMC429632	AMC429628	\$155.00
SILVER BONANZA	AMC433778	AMC433778	\$155.00
SILVER RIDGE	AMC434006	AMC434006	\$155.00
SILVER RIDGE NO 1	AMC434007	AMC434006	\$155.00
SILVER RIDGE NO 2	AMC434008	AMC434006	\$155.00
NORTH TIGER NO 1	AMC438557	AMC438557	\$155.00
STANDARD-BULL RUN	AMC438785	AMC438785	\$155.00
BENTON GEN NO 16	AMC441664	AMC441664	\$155.00
GREY EAGLE EXT SOUTH	AMC448614	AMC448614	\$155.00
PF 18	AMC448714	AMC448714	\$155.00
PF 19	AMC448715	AMC448714	\$155.00
PF 20	AMC448716	AMC448714	\$155.00
PF 21	AMC448717	AMC448714	\$155.00
PF 22	AMC448718	AMC448714	\$155.00
PF 28	AMC448719	AMC448714	\$155.00
PF 29	AMC448720	AMC448714	\$155.00
PF 30	AMC448721	AMC448714	\$155.00
OUTPOST 33	AMC449379	AMC449379	\$155.00
OUTPOST 34	AMC449380	AMC449379	\$155.00
OUTPOST 42	AMC449381	AMC449379	\$155.00
OUTPOST 43	AMC449382	AMC449379	\$155.00

NO WARRANTY IS MADE BY BLM FOR USE OF THE DATA FOR PURPOSES NOT INTENDED BY BLM

**DEPARTMENT OF THE INTERIOR  
BUREAU OF LAND MANAGEMENT  
MINING CLAIMS**

Run Date/Time: 8/20/2018

**MC Maintenance Fees Paid Through the BLM Pay Portal  
(by Date Paid)**

Page 82 Of 316

OUTPOST 53	AMC449383	AMC449379	\$155.00
OUTPOST 54	AMC449384	AMC449379	\$155.00
RIDGETOP LODE	AMC450151	AMC450151	\$155.00

**United States Department of the Interior****Bureau of Land Management**

BUSINESS &amp; SUPPORT SVCS DIV

ONE N CENTRAL AVE SUITE 800

PHOENIX, AZ 85004 -4427

Phone: 602-417-9200

Receipt

No:

4232593

<b>Transaction #:</b> 4347904	
<b>Date of Transaction:</b> 08/10/2018	
CUSTOMER:	
	F N HAWKINS 2222 W CLEAARVIEW TRAIL ANTHEM, AZ 85086 US

LINE #	QTY	DESCRIPTION	REMARKS	UNIT PRICE	TOTAL
1	1.00	LOCATABLE MINERALS / MINING CLAIMS- NOT NEW-UNADJUD, ONE AUTH NO. ONLY / MINING CLAIM MONEY RECEIVED CASES: AMC386588/\$9610.00		- n/a -	9610.00
<b>TOTAL:</b>					<b>\$9,610.00</b>

PAYMENT INFORMATION			
NOTE: Items will appear on credit card statement as "BLM O Mining Claim".			
1	AMOUNT:	9610.00	POSTMARKED: N/A
	TYPE:	CREDIT CARD	RECEIVED: 08/10/2018
	NAME:	F N HAWKINS 2222 W CLEAARVIEW TRAIL ANTHEM AZ 85086 US	
	CARD NO:	XXXXXXXXXXXX0411	AUTH CODE: 01050P
	NAME ON CARD:	F N HAWKINS	
	SIGNATURE:		

REMARKS

This receipt was generated by the automated BLM Collections and Billing System and is a paper representation of a portion of the official electronic record contained therein.

UNITED STATES  
DEPARTMENT OF THE INTERIOR  
BUREAU OF LAND MANAGEMENT

MAINTENANCE FEE WAIVER CERTIFICATION

SEE INSTRUCTIONS ON PAGE 2

78  
JMC

AMC351576

364364

413502

FORM APPROVED

OMB NO. 1004-0114

Expires: January 31, 2020

429544  
429628

1. This small miner waiver is filed for the assessment year beginning on September 1, 2017 and ending on September 1, 2018.
2. The undersigned and all related parties owned ten or fewer mining claims, mill, or tunnel sites located and maintained on Federal lands in the United States of America on September 1, 2017.
3. The undersigned have performed the assessment work required by law for each mining claim listed prior to filing this waiver and understand that by filing this form, the undersigned must file an affidavit of assessment work with the Bureau of Land Management (BLM) by the December 30th following the filing of this waiver.
4. The undersigned understand that if the assessment work obligation has not yet come due under 30 U.S.C. 28 (for those claims in their first assessment year only), a notice of intent to hold reciting this condition must be recorded by the December 30th following the filing of this waiver.
5. The undersigned understand that mill and tunnel sites may also be listed on this waiver and be waived from payment of the maintenance fee, and that a notice of intent to hold for these sites is required to be filed with the BLM by the December 30th following the filing of this waiver.
6. The undersigned understand and acknowledge that pursuant to 43 U.S.C. 1212 and 18 U.S.C. 1001, the filing or recording of a false, fictitious, or fraudulent document with the BLM may result in a fine of up to \$250,000, a prison term not to exceed five years, or both.
7. The mining claims, mill or tunnel sites for which this waiver from payment of the maintenance fees is requested are:

CLAIM OR SITE NAME	BLM RECORDATION SERIAL NUMBER
1. Copper Cliff Lode	AMC351576
2. Copper Cliff #2	AMC364364
3. Growler	AMC413502
4. Savoy 1	AMC429544
5. Savoy 2	AMC429545
6. Savoy 14	AMC429628
7. Savoy 15	AMC429629
8. Savoy 16	AMC429630
9. Savoy 17	AMC429631
10. Savoy 18	AMC429632

The owner(s) (claimants) of the above mining claims and sites are:

McIntyre Mines, LLC

(Owner's Name - Please Print)

3760 NW 183rd Ave

(Owner's Mailing Address)

Manager  
Portland

(Owner's Signature)

OR 97229

(City) (State) (Zip Code)

(Owner's Name - Please Print)

(Owner's Signature)

(Owner's Mailing Address)

(City)

(State)

(Zip Code)

(Owner's Name - Please Print)

(Owner's Signature)

(Owner's Mailing Address)

(City)

(State)

(Zip Code)

(Owner's Name - Please Print)

(Owner's Signature)

(Owner's Mailing Address)

(City)

(State)

(Zip Code)

(Continued on page 2)

ENTERED  
AC 483 (2018)  
SEP 01 2017  
BY: PB

RECEIVED  
JUL 17 2018  
3:13  
PHOENIX, ARIZONA

UNITED STATES DEPARTMENT OF THE INTERIOR  
BUREAU OF LAND MANAGEMENT

MC NATIONWIDE CLAIMANT LISTING  
September 01, 2017

Cust	AZ	National
	CLAIMANT	Total
MCINTYRE MINES LLC 3760 NW 183RD AVE PORTLAND, OR 97229-3320	10	10

DEPARTMENT OF THE INTERIOR  
BUREAU OF LAND MANAGEMENT  
MINING CLAIMS

MC Customer Information - With Serial No. and Claim Name  
ACTIVE CLAIMS

Admin State: AZ  
Geo State: AZ

MCINTYRE MINES LLC  
3760 NW 183RD AVE  
PORTLAND, OR 97229-3320

CUSTOMER ID: 2112467

5 lead #s

<u>Serial No.</u>	<u>Claim Name/Number</u>	<u>Lead Serial No.</u>	<u>Disposition</u>
AMC351576	COPPER CLIFF #1	AMC351576 -	ACTIVE
AMC364364	COPPER CLIFF #2	AMC364364 -	ACTIVE
AMC413502	GROWLER LODGE	AMC413502 -	ACTIVE
AMC429544	SAVOY 1	AMC429544 -	ACTIVE
AMC429545	SAVOY 2	AMC429544	ACTIVE
AMC429628	SAVOY 14	AMC429628 -	ACTIVE
AMC429629	SAVOY 15	AMC429628	ACTIVE
AMC429630	SAVOY 16	AMC429628	ACTIVE
AMC429631	SAVOY 17	AMC429628	ACTIVE
AMC429632	SAVOY 18	AMC429628	ACTIVE

Number of ACTIVE cases: 10

Run Date: 08/28/17

Run Time: 12:44 PM

**DEPARTMENT OF THE INTERIOR  
BUREAU OF LAND MANAGEMENT  
MINING CLAIMS**

**MC Maintenance Fees Paid Through the BLM Pay Portal**

**CBS Receipt: 3953859**

Printed For Lead File # AMC413502

Agency Tracking ID: 1503534805

Assessment Year: 2018

Number of BLM Serial Nr: 8

Paid On: 08/23/2017

Total Amount Paid: \$1,240.00

Claim Name	BLM Serial No	Lead File No	Amount Paid
GROWLER LODGE	AMC413502	AMC413502	\$155.00
SAVOY 1	AMC429544	AMC429544	\$155.00
SAVOY 2	AMC429545	AMC429544	\$155.00
SAVOY 14	AMC429628	AMC429628	\$155.00
SAVOY 15	AMC429629	AMC429628	\$155.00
SAVOY 16	AMC429630	AMC429628	\$155.00
SAVOY 17	AMC429631	AMC429628	\$155.00
SAVOY 18	AMC429632	AMC429628	\$155.00

**United States Department of the Interior**  
**Bureau of Land Management**  
 BUSINESS & SUPPORT SVCS DIV  
 ONE N CENTRAL AVE SUITE 800  
 PHOENIX, AZ 85004 -4427  
 Phone: 602-417-9200

Receipt

No: 3953859

<b>Transaction #:</b> 4063606	
<b>Date of Transaction:</b> 08/23/2017	
<b>CUSTOMER:</b>	
	F N HAWKINS 2222 W CLEARVIEW TRAIL ANTHEM, AZ 85086 US

LINE #	QTY	DESCRIPTION	REMARKS	UNIT PRICE	TOTAL
1	1.00	LOCATABLE MINERALS / MINING CLAIMS- NOT NEW-UNADJUD, ONE AUTH NO. ONLY / MINING CLAIM MONEY RECEIVED CASES: AMC429545/\$1240.00		- n/a -	1240.00
<b>TOTAL:</b>					<b>\$1,240.00</b>

PAYMENT INFORMATION			
NOTE: Items will appear on credit card statement as "BLM O Mining Claim".			
1	AMOUNT:	1240.00	POSTMARKED: N/A
	TYPE:	CREDIT CARD	RECEIVED: 08/23/2017
	NAME:	F N HAWKINS 2222 W CLEARVIEW TRAIL ANTHEM AZ 85086 US	
	CARD NO:	XXXXXXXXXXXX0411	AUTH CODE: 02363P
	NAME ON CARD:	F N HAWKINS	
	EXPIRES:	05/2020	
	SIGNATURE:		

REMARKS

This receipt was generated by the automated BLM Collections and Billing System and is a paper representation of a portion of the official electronic record contained therein.

Run Date: 08/28/17

Run Time: 12:44 PM

**DEPARTMENT OF THE INTERIOR  
BUREAU OF LAND MANAGEMENT  
MINING CLAIMS**

**MC Maintenance Fees Paid Through the BLM Pay Portal**

**CBS Receipt: 3953860**

Printed For Lead File # AMC413502

Agency Tracking ID: 1503535073

Assessment Year: 2018

Number of BLM Serial Nr: 8

Paid On: 08/23/2017

Total Amount Paid: \$1,240.00

Claim Name	BLM Serial No	Lead File No	Amount Paid
GROWLER LODE	AMC413502	AMC413502	\$155.00
SAVOY 1	AMC429544	AMC429544	\$155.00
SAVOY 2	AMC429545	AMC429544	\$155.00
SAVOY 14	AMC429628	AMC429628	\$155.00
SAVOY 15	AMC429629	AMC429628	\$155.00
SAVOY 16	AMC429630	AMC429628	\$155.00
SAVOY 17	AMC429631	AMC429628	\$155.00
SAVOY 18	AMC429632	AMC429628	\$155.00

**United States Department of the Interior**  
**Bureau of Land Management**  
 BUSINESS & SUPPORT SVCS DIV  
 ONE N CENTRAL AVE SUITE 800  
 PHOENIX, AZ 85004 -4427  
 Phone: 602-417-9200

Receipt

No: 3953860

<b>Transaction #:</b> 4063607	
<b>Date of Transaction:</b> 08/23/2017	
CUSTOMER:	
	F N HAWKINS 2222 W CLEARVIEW TRAIL ANTHEM, AZ 85086 US

LINE #	QTY	DESCRIPTION	REMARKS	UNIT PRICE	TOTAL
1	1.00	LOCATABLE MINERALS / MINING CLAIMS- NOT NEW-UNADJUD, ONE AUTH NO. ONLY / MINING CLAIM MONEY RECEIVED CASES: AMC429545/\$1240.00		- n/a -	1240.00
<b>TOTAL:</b>					<b>\$1,240.00</b>

PAYMENT INFORMATION			
NOTE: Items will appear on credit card statement as "BLM O Mining Claim".			
1	AMOUNT:	1240.00	POSTMARKED: N/A
	TYPE:	CREDIT CARD	RECEIVED: 08/23/2017
	NAME:	F N HAWKINS 2222 W CLEARVIEW TRAIL ANTHEM AZ 85086 US	
	CARD NO:	XXXXXXXXXXXX0411	AUTH CODE: 02326P
	NAME ON CARD:	F N HAWKINS	
	EXPIRES:	05/2020	
	SIGNATURE:		

REMARKS

This receipt was generated by the automated BLM Collections and Billing System and is a paper representation of a portion of the official electronic record contained therein.

Return to:  
Frederick C. Bauman  
6440 Sky Pointe Dr,  
Ste 140-412  
Las Vegas, NV 89131

413502  
429544  
429628

### MAINTENANCE FEE PAYMENT

Claimant Name: Clark Copper Mines, LLC  
Address: 6440 Sky Pointe Dr, Ste 140-412  
City: Las Vegas State: NV Zip: 89131  
Telephone: (702) 533-8372  
E-mail address: searchlightwest@aol.com  
Signature: Frederick C Bauman

☐ Check here if this is a change of address.

BLM Date Stamp	RECEIVED BLM AT STATE OFFICE PHOENIX, ARIZONA 2016 JUN 27 P 3:00
----------------------	---

LINE NO.	AMC NUMBER	CLAIM/SITE NAME	COUNTY RECORDER DATA (If available)	TWP	RNG	SEC
1	413502	Growler	Bk 4857, p. 885	10N	1W	26
2		amended	2014-0040821	10N	1W	35
3	429544	Savoy 1	2014-0040822	10N	1W	26
4	429545	Savoy 2	2014-0040823	10N	1W	26
5	429628	Savoy 14	2014-0040824	10N	1W	26
6	429629	Savoy 15	2014-0040825	10N	1W	26, 27
7	429630	Savoy 16	2014-0040826	10N	1W	26, 27
8	429631	Savoy 17	2014-0040827	10N	1W	26, 27
9	429632	Savoy 18	2014-0040828	10N	1W	26, 27
10						

List additional claims on Form MCF114.

Bureau of Land Management  
Arizona State Office  
[www.blm.gov/az/](http://www.blm.gov/az/)

No. of Claims*: <u>9</u> x \$155 = <u>\$1240.00</u>
Check No: <u>1527</u> Init. <u>ACB</u>
Receipt No.: <u>3594242</u>
For BLM Use Only

SAYS 9 CLAIMS BUT ONLY 8. \$155 x 8 = \$1240

\* \$155 per lode mining claim, mill site, or tunnel site; and \$155 for each 20 acres or portion thereof for each placer mining claim.

Form: MCF112  
Revised July 2014

ENTERED  
JUN 30 2016  
BY: [Signature]

This form is available from the Arizona Geological Survey and may be reproduced.

Bauman  
6440 Sky Pointe Dr,  
Ste 140-149

Las Vegas, NV 89131

106 WEBS  
NV 890  
23 JUN '16  
PM 51



C403605 11234658

FOREVER



BLM  
1 N. Central Ave, Ste 800  
Phoenix, AZ 85004

PHOENIX ARIZONA

2016 JUN 27 P 3:00

RECEIVED  
BLM AT STATE OFFICE

Attn: Mining Claims

85004-442700

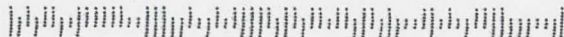

**United States Department of the Interior**  
**Bureau of Land Management**  
DIV OF LANDS, MINRLS & ENERGY  
ONE N CENTRAL AVE  
PHOENIX, AZ 85004 -4427  
Phone: 602-417-9200

Receipt

No: 3594242

<b>Transaction #:</b> 3697486	
<b>Date of Transaction:</b> 06/28/2016	
CUSTOMER:	
	FREDERICK C BAUMAN 6440 SKY POINTE DR STE 140-149 LAS VEGAS,NV 89131-4047 US

LINE #	QTY	DESCRIPTION	REMARKS	UNIT PRICE	TOTAL
1	1.00	LOCATABLE MINERALS / MINING CLAIMS- NOT NEW-UNADJUD,ONE AUTH NO. ONLY / MINING CLAIM MONEY RECEIVED CASES: AMC413502/\$1240.00	MAINT FEE PYMNT <del>9</del> 2017 b	- n/a -	1240.00
TOTAL:					\$1,240.00

PAYMENT INFORMATION				
1	AMOUNT:	1240.00	POSTMARKED:	06/23/2016
	TYPE:	CHECK	RECEIVED:	06/27/2016
	CHECK NO:	1527		
	NAME:	SEARCHLIGHT EXPLORATION LLC 6440 SKY POINTE DR STE 140-149 LAS VEGAS NV 89131-4047 US		

REMARKS

This receipt was generated by the automated BLM Collections and Billing System and is a paper representation of a portion of the official electronic record contained therein.

Return to  
Frederick C. Bauman  
6440 Sky Pointe Dr.,  
Ste 140-149  
Las Vegas NV 89131

413502  
429544  
429628

# MAINTENANCE FEE PAYMENT

Claimant Name: Clark Copper Mines, LLC  
Address: 6440 Sky Pointe Dr, Ste 140-412  
City: Las Vegas State: NV Zip: 89131  
Telephone: (702) 533-8372  
E-mail address: searchlightwest@aol.com  
Signature: Frederick C Bauman

☐ Check here if this is a change of address.

BLM Date Stamp	PHOENIX, ARIZONA	2015 JUL -1 P 3:07	BLM Date Stamp
----------------------	------------------	--------------------	----------------------

LINE NO.	AMC NUMBER	CLAIM/SITE NAME	COUNTY RECORDER DATA (If available)	TWP	RNG	SEC
1	413502	Growler	Bl 4857, p. 885	10N	1W	26
2		amended	2014-0040821	10N	1W	35
3	429544	Savoy 1	2014-0040822	10N	1W	26
4	429545	Savoy 2	2014-0040823	10N	1W	26
5	429546	Savoy 19	2014-0040829	10N	1W	26, 35
6	429628	Savoy 14	2014-0040824	10N	1W	26
7	429629	Savoy 15	2014-0040825	10N	1W	26, 27
8	429630	Savoy 16	2014-0040826	10N	1W	26, 27
9	429631	Savoy 17	2014-0040827	10N	1W	26, 27
10	429632	Savoy 18	2014-0040828	10N	1W	26, 27

List additional claims on Form MCF114.

Bureau of Land Management  
Arizona State Office  
[www.blm.gov/az/](http://www.blm.gov/az/)

No. of Claims\*: 9 x \$155 = 1395.00  
Check No: 1570 Init. AK  
Receipt No.: 3337841  
For BLM Use Only

\* \$155 per lode mining claim, mill site, or tunnel site; and \$155 for each 20 acres or portion thereof for each placer mining claim.

Form: MCF112  
Revised July 2014

This form is available from the Arizona Geological Survey and may be reproduced.

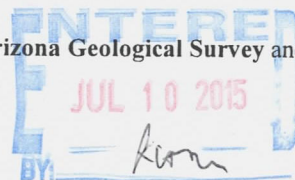

Bauman  
6440 Sky Pointe Dr.,  
Ste 140-149

Las Vegas, NV 89131

LAS VEGAS  
NV 890  
29 JUN '15  
PM 5 L

RECEIVED  
BLM ALBUQUERQUE OFFICE

2015 JUL -7 P 3: 06

PHOENIX, ARIZONA

USDO1 /BLM  
1 N. Central Ave,  
Ste 800

Phoenix, AZ 85004

Attn: Mining Claims

25004441499



A20250509 185542

FOREVER



CK



**United States Department of the Interior**  
**Bureau of Land Management**  
 LANDS/RECREATION & PLANNING  
 ONE N CENTRAL AVE  
 PHOENIX, AZ 85004 -2203  
 Phone: 602-417-9200

Receipt

No: 3337841

<b>Transaction #:</b> 3435413	
<b>Date of Transaction:</b> 07/08/2015	
CUSTOMER:	
CLARK COPPER MINES LLC ATTN.: FREDERICK C BAUMAN ESQ 6440 SKY POINTE DR STE 140-149 LAS VEGAS,NV 89131-4047 US	

LINE #	QTY	DESCRIPTION	REMARKS	UNIT PRICE	TOTAL
1	1.00	LOCATABLE MINERALS / MINING CLAIMS- NOT NEW-UNADJUD,ONE AUTH NO. ONLY / MINING CLAIM MONEY RECEIVED <b>CASES:</b> AMC413502/\$1395.00	MAINT FEE PYMNT (9) 2016	- n/a -	1395.00
<b>TOTAL:</b>					<b>\$1,395.00</b>

PAYMENT INFORMATION			
1	AMOUNT:	1395.00	POSTMARKED: 06/29/2015
	TYPE:	CHECK	RECEIVED: 07/07/2015
	CHECK NO:	1570	
	NAME:	SEARCHLIGHT EXPLORATION LLC 6440 SKY POINTE DR STE 140-412 LAS VEGAS NV 89131 US	

REMARKS

This receipt was generated by the automated BLM Collections and Billing System and is a paper representation of a portion of the official electronic record contained therein.

ENTERED  
 JUL 10 2015  
 BY: *Rosen*

AMC 357922

360022

415232

413502

400313

Return To:

Frederick C. Bauman  
6440 Sky Pointe Dr.,  
STE 140-149

Las Vegas, NV 89131

## MAINTENANCE FEE PAYMENT

Claimant Name: Searchlight Exploration, LLC  
 Address: 6440 Sky Pointe Dr., Ste 140-412  
 City: Las Vegas State: NV Zip: 89131  
 Telephone: (702) 533-8372  
 E-mail address: Searchlightwest@aol.com  
 Signature: Frederick C. Bauman

☐ Check here if this is a change of address.

BLM  
Date  
Stamp

PHOENIX, ARIZONA

2014 JUL 22 P 3:01

RECEIVED  
BLM AZ STATE OFFICE

LINE NO.	AMC NUMBER	CLAIM/SITE NAME	COUNTY RECORDER DATA (If available)	TWP	RNG	SEC
1	357922	Big John hole	BK 4480 p. 821	19N	20W	22,23
2	360022	Argo hole	BK 4807 p. 100	19N	20W	24
3	415232	BJ #1*	Fee 2012017150	19N	20W	22,23
4		amended	Fee 2013002242			
5						
6						
7						
8						
9						
10						

List additional claims on Form MCF114.

\* Additional claimants listed  
on Exhibit "A"

Bureau of Land Management  
Arizona State Office  
www.blm.gov/az/

No. of Claims: \_\_\_\_\_ x \$140 = \_\_\_\_\_

Check No: \_\_\_\_\_ Init. \_\_\_\_\_

Receipt No.: \_\_\_\_\_

For BLM Use Only

#3083471

Form: MCF112  
Revised July 2009

This form is available from the Arizona Department of Mines and Mineral Resources and may be reproduced.

ENTERED  
JUL 24 2014  
BY: RAM

EXHIBIT "A"

BIG JOHN (BJ) PLACER ASSOCIATION

Frederick C. Bauman, 6440 Sky Pointe Dr., Ste 140-149, Las Vegas, NV 89131  
Barbara M. Bauman, 6440 Sky Pointe Dr., Ste 140-149, Las Vegas, NV 89131  
Anaconda Exploration, LLC, 6440 Sky Pointe Dr., Ste 140-412, Las Vegas, NV 89131  
McIntyre & Bauman Group, LLC, 6440 Sky Pointe Dr., Ste 140-412, Las Vegas, NV 89131  
Middle Verde Development Co., LLC, 6440 Sky Pointe Dr., Ste 140-412, Las Vegas, NV 89131  
Searchlight Exploration, LLC, 6440 Sky Pointe Dr., Ste 140-412, Las Vegas, NV 89131  
Jeffrey W. Compton, 6115 Grand Teton Dr., Las Vegas, NV 89131  
Thomas A. Climo, 7300 Cogburn St., Las Vegas, NV 89131

RECEIVED  
FLM AZ STATE OFFICE  
2014 JUL 22 P 3:01  
PHOENIX, ARIZONA

Return to:

Frederick C. Bauman, Esq.

6440 Sky Pointe Dr, Ste

140-149

Las Vegas, NV 89131

**MAINTENANCE FEE PAYMENT**

Claimant Name: Searchlight Strategic Resources, LLC

Address: 6440 Sky Pointe Dr, Ste 140-412

City: Las Vegas State: NV Zip: 89131

Telephone: (702) 533-8372

E-mail address: searchlightwest@aol.com

Signature: Frederick C. Bauman

☐ Check here if this is a change of address.

BLM  
Date  
Stamp

PHOENIX, ARIZONA

2014 JUL 22 P 3:01

RECEIVED  
BLM AZ STATE OFFICE

LINE NO.	AMC NUMBER	CLAIM/SITE NAME	COUNTY RECORDER DATA (If available)	TWP	RNG	SEC
1	399138	Rare Metals #2	Fee #2010001038	17N	12W	23,24
2						
3						
4						
5						
6						
7						
8						
9						
10						

List additional claims on Form MCF114.

Bureau of Land Management  
Arizona State Office  
[www.blm.gov/az/](http://www.blm.gov/az/)

No. of Claims: \_\_\_\_\_ x \$140 = \_\_\_\_\_

Check No: \_\_\_\_\_ Init. \_\_\_\_\_

Receipt No.: \_\_\_\_\_

For BLM Use Only

Form: MCF112  
Revised July 2009

This form is available from the Arizona Department of Mines and Mineral Resources and may be reproduced.

Return to:

Frederick C. Bauman, Esq.  
6440 Sky Pointe Dr.  
Ste 140-149  
Las Vegas, NV 89131

**MAINTENANCE FEE PAYMENT**

Claimant Name: Searchlight Strategic Resources LLC  
Address: 6440 Sky Pointe Dr, Ste 140-412  
City: Las Vegas State: NV Zip: 89131  
Telephone: (702) 533-8372  
E-mail address: searchlightwest@aol.com  
Signature: Frederick C. Bauman

☐ Check here if this is a change of address.

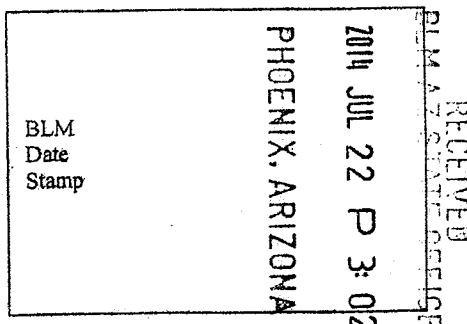

LINE NO.	AMC NUMBER	CLAIM/SITE NAME	COUNTY RECORDER DATA (If available)	TWP	RNG	SEC
1	400313	KF#1	Fee # 2010009210	22N	17W	26
2	400314	KF#2	Fee # 2010009211	22N	17W	26
3						
4						
5						
6						
7						
8						
9						
10						

List additional claims on Form MCF114.

Bureau of Land Management  
Arizona State Office  
[www.blm.gov/az/](http://www.blm.gov/az/)

No. of Claims: \_\_\_\_\_ x \$140 = \_\_\_\_\_  
Check No: \_\_\_\_\_ Init. \_\_\_\_\_  
Receipt No.: \_\_\_\_\_  
For BLM Use Only

Form: MCF112  
Revised July 2009

This form is available from the Arizona Department of Mines and Mineral Resources and may be reproduced.

Return to:

Frederick C. Bauman, Esq.  
6440 Sky Pointe Dr., Ste  
140-149  
Las Vegas, NV 89131

**MAINTENANCE FEE PAYMENT**

Claimant Name: Clark Copper Mines, LLC  
Address: 6440 Sky Pointe Dr., Ste 140-412  
City: Las Vegas State: NV Zip: 89131  
Telephone: (702) 533-8372  
E-mail address: Searchlightwest@aol.com  
Signature: Frederick C. Bauman

☐ Check here if this is a change of address.

RECEIVED  
2014 JUL 22 P 3:02  
PHOENIX, ARIZONA  
BLM  
Date  
Stamp

LINE NO.	AMC NUMBER	CLAIM/SITE NAME	COUNTY RECORDER DATA (if available)	TWP	RNG	SEC
1	413502	Growler	BK 4865 Pg 137	10N	10W	26
2				10N	10W	35
3						
4						
5						
6						
7						
8						
9						
10						

List additional claims on Form MCF114.

Bureau of Land Management  
Arizona State Office  
[www.blm.gov/az/](http://www.blm.gov/az/)

No. of Claims: \_\_\_\_\_ x \$140 = \_\_\_\_\_  
Check No: \_\_\_\_\_ Init. \_\_\_\_\_  
Receipt No.: \_\_\_\_\_  
For BLM Use Only

Form: MCF112  
Revised July 2009

This form is available from the Arizona Department of Mines and Mineral Resources and may be reproduced.

**SEARCHLIGHT EXPLORATION, LLC**

**6440 Sky Point e Dr., Ste 140-412**

**Las Vegas, NV 89131**

**(702) 533-8372**

**searchlightwest@aol.com**

July 19, 2014

Bureau of Land Management  
Arizona State Office  
1 North Central Ave., Suite 800  
Phoenix, AZ 85004

Re: \$15 per Claim Increase in Annual Mining Claim Maintenance Fee

Ladies and Gentlemen:

Unfortunately we only learned of your recent price increase yesterday. Enclosed is a check for \$105 to cover the price increase for the seven (7) unpatented claims identified in the enclosed Form MCF211.

Sincerely yours,



Frederick C. Bauman, Manager

Enclosure

RECEIVED  
BLM AZ STATE OFFICE  
2014 JUL 22 P 3:01  
PHOENIX, ARIZONA

Saunders  
6440 Sky Pointe Dr,  
Ste 140-149  
Las Vegas, NV 89131

RECEIVED  
BLM AZ STATE OFFICE  
2014 JUL 21 P 3:16

PHOENIX, ARIZONA

USDO / BLM  
1 N. Central Ave, Suite 800  
Phoenix, AZ 85004

Attn: Mining Claims 85004442700

LAS VEGAS NV 890

18 JUL 2014 PM 4 L

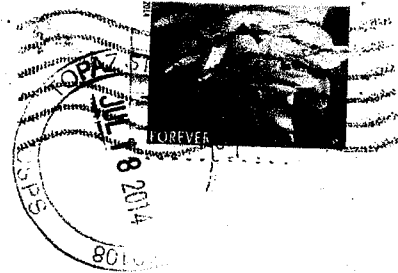

**United States Department of the Interior**  
**Bureau of Land Management**  
 LANDS/RECREATION & PLANNING  
 ONE N CENTRAL AVE  
 PHOENIX, AZ 85004 -2203  
 Phone: 602-417-9200

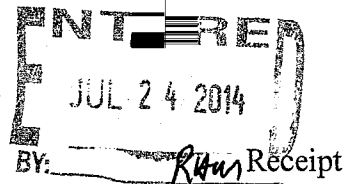

No: 3083471

**Transaction #:** 3174771  
**Date of Transaction:** 07/23/2014

**CUSTOMER:**

FREDERICK C BAUMAN  
 6440 SKY POINTE DR STE 140-149  
 LAS VEGAS, NV 89131-4047 US

LINE #	QTY	DESCRIPTION	REMARKS	UNIT PRICE	TOTAL
1	1.00	LOCATABLE MINERALS / MINING CLAIMS-NOT NEW-UNADJUD, ONE AUTH NO. ONLY / MINING CLAIM MONEY RECEIVED CASES: AMC357922/\$105.00	ADDITIONAL MAINT FEES	- n/a -	105.00
<b>TOTAL:</b>					<b>\$105.00</b>

PAYMENT INFORMATION				
1	AMOUNT:	105.00	POSTMARKED:	07/19/2014
	TYPE:	CHECK	RECEIVED:	07/22/2014
	CHECK NO:	1514		
	NAME:	SEARCHLIGHT EXPLORATION LLC 6440 SKY POINTE DR STE 140-149 LAS VEGAS NV 89131-4047 US		

**REMARKS**

This receipt was generated by the automated BLM Collections and Billing System and is a paper representation of a portion of the official electronic record contained therein.

AMC 357922  
360022  
415232  
413502  
400313

Return To:  
Frederick C. Bauman  
6440 Sky Pointe Dr.,  
Ste 140-149  
Las Vegas, NV 89131

680

**MAINTENANCE FEE PAYMENT**

Claimant Name: Searchlight Exploration, LLC  
Address: 6440 Sky Pointe Dr., Ste 140-412  
City: Las Vegas State: NV Zip: 89131  
Telephone: (702) 533-8372  
E-mail address: Searchlightwest@aol.com  
Signature: Frederick C Bauman

RECEIVED  
2014 JUL 21 P 3:39  
PHOENIX, ARIZONA  
BLM  
Date  
Stamp

☐ Check here if this is a change of address.

LINE NO.	AMC NUMBER	CLAIM/SITE NAME	COUNTY RECORDER DATA (If available)	TWP	RNG	SEC
1	357922	Big John Hole	Bk 4480 p. 821	19N	20W	22,23
2	360022	Argo Hole	BK 4807 p. 100	19N	20W	24
3	415232	BJ #1*	Fee 2012017150	19N	20W	22,23
4		amended	Fee 2013002242			
5						
6						
7						
8						
9						
10						

List additional claims on Form MCF114.

\* Additional claimants listed on Exhibit "A"

Bureau of Land Management  
Arizona State Office  
www.blm.gov/az/

No. of Claims: 7 x \$140 = 980.00?  
Check No: 1513 Init. MLL  
Receipt No.: 3082536  
For BLM Use Only

499  
ADDITIONAL PAYMENT 07/22/2014  
CURED RM

Form: MCF112  
Revised July 2009

This form is available from the Arizona Department of Mines and Mineral Resources and may be reproduced.

ENTERED  
JUL 24 2014  
BY: RAM

EXHIBIT "A"

BIG JOHN (BJ) PLACER ASSOCIATION

Frederick C. Bauman, 6440 Sky Pointe Dr., Ste 140-149, Las Vegas, NV 89131  
Barbara M. Bauman, 6440 Sky Pointe Dr., Ste 140-149, Las Vegas, NV 89131  
Anaconda Exploration, LLC, 6440 Sky Pointe Dr., Ste 140-412, Las Vegas, NV 89131  
McIntyre & Bauman Group, LLC, 6440 Sky Pointe Dr., Ste 140-412, Las Vegas, NV 89131  
Middle Verde Development Co., LLC, 6440 Sky Pointe Dr., Ste 140-412, Las Vegas, NV 89131  
Searchlight Exploration, LLC, 6440 Sky Pointe Dr., Ste 140-412, Las Vegas, NV 89131  
Jeffrey W. Compton, 6115 Grand Teton Dr., Las Vegas, NV 89131  
Thomas A. Climo, 7300 Cogburn St., Las Vegas, NV 89131

PHOENIX, ARIZONA

2014 JUL 21 P 3:39

RECEIVED  
PLMAD 8/1/14 11:05

Return to:  
 Frederick C. Bauman, Esq.  
 6440 Sky Pointe Dr, Ste  
 140-149  
 Las Vegas, NV 89131

**MAINTENANCE FEE PAYMENT**

Claimant Name: Clark Copper Mines, LLC  
 Address: 6440 Sky Pointe Dr, Ste 140-412  
 City: Las Vegas State: NV Zip: 89131  
 Telephone: (702) 533-8372  
 E-mail address: searchlightwest@aol.com  
 Signature: Frederick C Bauman

☐ Check here if this is a change of address.

BLM  
Date  
Stamp

PHOENIX, ARIZONA

JUL 21 P 3:39

RECEIVED

LINE NO.	AMC NUMBER	CLAIM/SITE NAME	COUNTY RECORDER DATA (If available)	TWP	RNG	SEC
1	413502	Growler	BK 4865 Pg 137	10N	10W	26
2				10N	10W	35
3						
4						
5						
6						
7						
8						
9						
10						

List additional claims on Form MCF114.

Bureau of Land Management  
 Arizona State Office  
[www.blm.gov/az/](http://www.blm.gov/az/)

No. of Claims: \_\_\_\_\_ x \$140 = \_\_\_\_\_  
 Check No: \_\_\_\_\_ Init. \_\_\_\_\_  
 Receipt No.: \_\_\_\_\_  
 For BLM Use Only

Form: MCF112  
 Revised July 2009

This form is available from the Arizona Department of Mines and Mineral Resources and may be reproduced.

Return to:

Frederick C. Bauman, Esq.  
6440 Sky Pointe Dr.  
Ste 140-149  
Las Vegas, NV 89131

**MAINTENANCE FEE PAYMENT**

Claimant Name: Searchlight Strategic Resources, LLC  
Address: 6440 Sky Pointe Dr, Ste 140-412  
City: Las Vegas State: NV Zip: 89131  
Telephone: (702) 533-8372  
E-mail address: searchlightwest@aol.com  
Signature: Frederick C. Bauman

☐ Check here if this is a change of address.

RECEIVED  
BLM / ARIZONA OFFICE  
JUL 21 P 3:39  
PHOENIX, ARIZONA

BLM  
Date  
Stamp

LINE NO.	AMC NUMBER	CLAIM/SITE NAME	COUNTY RECORDER DATA (If available)	TWP	RNG	SEC
1	400313	KF#1	Fee# 2010009210	22N	17W	26
2	400314	KF#2	Fee# 2010009211	22N	17W	26
3						
4						
5						
6						
7						
8						
9						
10						

List additional claims on Form MCF114.

Bureau of Land Management  
Arizona State Office  
[www.blm.gov/az/](http://www.blm.gov/az/)

No. of Claims: \_\_\_\_\_ x \$140 = \_\_\_\_\_  
Check No: \_\_\_\_\_ Init. \_\_\_\_\_  
Receipt No.: \_\_\_\_\_  
For BLM Use Only

Form: MCF112  
Revised July 2009

This form is available from the Arizona Department of Mines and Mineral Resources and may be reproduced.

Return to:

Frederick C. Bauman, Esq.

6440 Sky Pointe Dr, Ste  
140-149

Las Vegas, NV 89131

**MAINTENANCE FEE PAYMENT**

Claimant Name: Searchlight Strategic Resources, LLC

Address: 6440 Sky Pointe Dr, Ste 140-412

City: Las Vegas State: NV Zip: 89131

Telephone: (702) 533-8372

E-mail address: searchlightwest@aol.com

Signature: Frederick C Bauman

☐ Check here if this is a change of address.

BLM  
Date  
Stamp

PHOENIX, ARIZONA

2014 JUL 21 P 3:39

RECEIVED  
MINERAL RIGHTS OFFICE

LINE NO.	AMC NUMBER	CLAIM/SITE NAME	COUNTY RECORDER DATA (If available)	TWP	RNG	SEC
1	399138	Rare Metals #2	Fee #2010001038	17N	12W	23, 24
2						
3						
4						
5						
6						
7						
8						
9						
10						

List additional claims on Form MCF114.

Bureau of Land Management  
Arizona State Office  
[www.blm.gov/az/](http://www.blm.gov/az/)

No. of Claims: \_\_\_\_\_ x \$140 = \_\_\_\_\_

Check No: \_\_\_\_\_ Init. \_\_\_\_\_

Receipt No.: \_\_\_\_\_

For BLM Use Only

Form: MCF112  
Revised July 2009

This form is available from the Arizona Department of Mines and Mineral Resources and may be reproduced.

Bansan  
Searchlight Exploration, LLC  
6440 Sky Pointe Dr.  
Ste 140-412  
Las Vegas, NV 89131

RECEIVED  
BLM AZ STATE OFFICE

2014 JUL 22 P 2:42

PHOENIX, ARIZONA

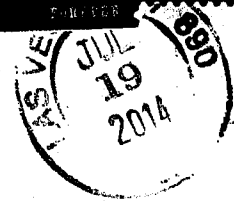
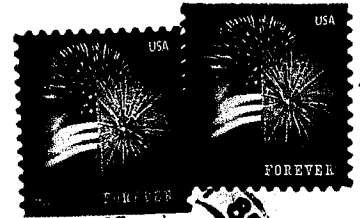

BLM - Arizona State Office  
1 North Central Ave, Ste 800

Phoenix, AZ

8500434427

85004

United States Department of the Interior  
Bureau of Land Management  
LANDS/RECREATION & PLANNING  
ONE N CENTRAL AVE  
PHOENIX, AZ 85004 -2203  
Phone: 602-417-9200

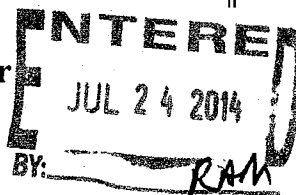

Receipt

No:

3082526

Transaction #: 3173820	
Date of Transaction: 07/22/2014	
CUSTOMER:	
	FREDERICK C BAUMAN 6440 SKY POINTE DR STE 140-149 LAS VEGAS,NV 89131-4047 US

LINE #	QTY	DESCRIPTION	REMARKS	UNIT PRICE	TOTAL
1	1.00	LOCATABLE MINERALS / MINING CLAIMS- NOT NEW-UNADJUD,ONE AUTH NO. ONLY / MINING CLAIM MONEY RECEIVED CASES: AMC357922/\$980.00	MAINT 2015/7	- n/a -	980.00
TOTAL:					\$980.00

PAYMENT INFORMATION				
1	AMOUNT:	980.00	POSTMARKED:	07/18/2014
	TYPE:	CHECK	RECEIVED:	07/21/2014
	CHECK NO:	1513		
	NAME:	SEARCHLIGHT EXPLORATION LLC 6440 SKY POINTE DR STE 140-149 LAS VEGAS NV 89131-4047 US		

REMARKS
CONTACTED CUST VIA PHONE ADVISED SHORT \$105/WILL SEND IN ADDITIONAL CHECK/TMC

This receipt was generated by the automated BLM Collections and Billing System and is a paper representation of a portion of the official electronic record contained therein.

Return to:  
Frederick C. Bauman, Esq.  
6440 Sky Pointe Dr, Ste  
140-149  
Las Vegas, NV 89131

362684  
413502

**MAINTENANCE FEE PAYMENT**

Claimant Name: Anaconda Exploration, LLC  
Address: 6440 Sky Pointe Dr, Ste 140-412  
City: Las Vegas State: NV Zip: 89131  
Telephone: (702) 533-8372  
E-mail address: searchlightwest@aol.com  
Signature: Frederick C. Bauman

☐ Check here if this is a change of address.

BLM  
Date  
Stamp

RECEIVED  
BLM AZ STATE OFFICE  
2013 AUG -7 AM 11:48  
PHOENIX, ARIZONA

LINE NO.	AMC NUMBER	CLAIM/SITE NAME	COUNTY RECORDER DATA (If available)	TWP	RNG	SEC
1	362684	Silver Lining Lode	Fee # 2004-04684	9N	11W	30
2						
3						
4						
5						
6						
7						
8						
9						
10						

List additional claims on Form MCF114.

Bureau of Land Management  
Arizona State Office  
[www.blm.gov/az/](http://www.blm.gov/az/)

No. of Claims: 1 x \$140 = 140.00  
Check No: 1387 Init. CAH  
Receipt No.: 2850041  
For BLM Use Only

Form: MCF112  
Revised July 2009

This form is available from the Arizona Department of Mines and Mineral Resources and may be reproduced.

ENTERED IN COMPUTER  
RE 8-19-13

Return to:  
 Frederick C. Bauman, Esq.  
 6440 Sky Pointe Dr., Ste 140-149  
 Las Vegas, NV 89131

**MAINTENANCE FEE PAYMENT**

Claimant Name: Clark Copper Mines, LLC.  
 Address: 6440 Sky Pointe Dr., Ste 140-412  
 City: Las Vegas State: NV Zip: 89131  
 Telephone: (702) 533-8372  
 E-mail address: searchlightwest@aol.com  
 Signature: Frederick C. Bauman  
☒ Check here if this is a change of address.

RECEIVED  
BLM AZ STATE OFFICE

2013 AUG - 7 AM 11:48  
 PHOENIX, ARIZONA

BLM  
Date  
Stamp

LINE NO.	AMC NUMBER	CLAIM/SITE NAME	COUNTY RECORDER DATA (if available)	TWP	RNG	SEC
1	413502	Growler	BLK 4865 & 137	10N	10W	26
2				10N	10W	35
3						
4						
5						
6						
7						
8						
9						
10						

List additional claims on Form MCF114.

Bureau of Land Management  
 Arizona State Office  
[www.blm.gov/az/](http://www.blm.gov/az/)

No. of Claims: 1 x \$140 = \$140.00  
 Check No: 1387 Init. A.A.  
 Receipt No.: 2850041  
 For BLM Use Only

Form: MCF112  
 Revised July 2009

This form is available from the Arizona Department of Mines and Mineral Resources and may be reproduced.

Bauman  
6440 Sky Bwite Dr.,  
Ste 140-149  
Las Vegas, NV 89131

RECEIVED  
BLM AZ STATE OFFICE

2013 AUG -7 AM 11:48

PHOENIX, ARIZONA

LAS VEGAS NV 890

05 AUG 2013 PM 4 L

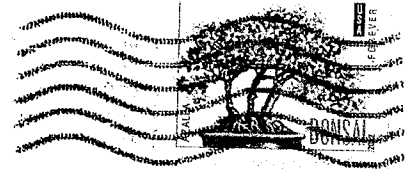

DOI/BLM  
Arizona State Office  
1 N Central Ave, Ste 800  
Phoenix, AZ

85004442700

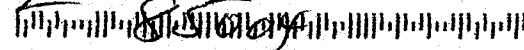

Attn: Mining Claims

**United States Department of the Interior**  
**Bureau of Land Management**  
LANDS/RECREATION & PLANNING  
ONE N CENTRAL AVE  
PHOENIX, AZ 85004 -2203  
Phone: 602-417-9200

Receipt

No: 2850041

**Transaction #:** 2935762**Date of Transaction:** 08/08/2013**CUSTOMER:**

FREDERICK BAUMAN  
6440 SKY POINTE DR STE 140-149  
LAS VEGAS,NV 89131-4047 US

LINE #	QTY	DESCRIPTION	REMARKS	UNIT PRICE	TOTAL
1	1.00	LOCATABLE MINERALS / MINING CLAIMS- NOT NEW-UNADJUD,ONE AUTH NO. ONLY / MINING CLAIM MONEY RECEIVED CASES: AMC362684/\$280.00	MAINT FEE PYMNT (2) 2014	- n/a -	280.00
<b>TOTAL:</b>					<b>\$280.00</b>

PAYMENT INFORMATION					
1	AMOUNT:	280.00		POSTMARKED:	08/05/2013
	TYPE:	CHECK		RECEIVED:	08/07/2013
	CHECK NO:	1387			
	NAME:	SEARCHLIGHT EXPLORATION LLC 9212 EMPIRE ROCK ST LAS VEGAS NV 89143 US			

**REMARKS**

This receipt was generated by the automated BLM Collections and Billing System and is a paper representation of a portion of the official electronic record contained therein.

Return to:  
Frederick C. Bauman, Esq.  
Rosenfeld Bauman & Forbes  
401 N. Buffalo Dr., #100  
Las Vegas, NV  
89145

AMC 396788  
AMC 411288  
AMC 410569  
FMC 413502

# MAINTENANCE FEE PAYMENT

Claimant Name: Clark Copper Mines, LLC (50%)  
Address: 9212 Empire Rock St  
City: Las Vegas State: NV Zip: 89143  
Telephone: (702) 533-8372  
E-mail address: searchlightwest@aol.com  
Signature: Frederick C. Bauman

☐ Check here if this is a change of address.

BLM  
Date  
Stamp

RECEIVED  
BLM AZ STATE OFFICE  
2012 AUG 31 A 10:34  
PHOENIX, ARIZONA

LINE NO.	AMC NUMBER	CLAIM/SITE NAME	COUNTY RECORDER DATA (If available)	TWP	RNG	SEC
1	396788	Calumet Prescott	BK 4675 Pg 875	10N	10W	26, 35
2	396789	Rapid Transit	BK 4675 Pg 874	10N	10W	26
3	396790	Rapid Transit East	BK 4675 Pg 873	10N	10W	26
4						
5						
6						
7						
8						
9						
10						

List additional claims on Form MCF114.

Bureau of Land Management  
Arizona State Office  
[www.blm.gov/az/](http://www.blm.gov/az/)

No. of Claims: 17 x \$140 = 2,380  
Check No: 1521 E 1522 Init. JMC  
Receipt No.: 2648525  
For BLM Use Only

\*Additional owner: John B. Rothermel, Jr., 5822 W. Michelle Dr., AZ 85308 Form: MCF112  
Revised July 2009

This form is available from the Arizona Department of Mines and Mineral Resources and may be reproduced.

PS 9-11-12

ENTERED IN COMPUTER

Return to:

Frederick C. Bauman, Esq.  
Rosenfeld Bauman + Fikes  
401 N. Buffalo Dr., #100  
Las Vegas, NV 89145

**MAINTENANCE FEE PAYMENT**

Claimant Name: Clark Copper Mines, LLC  
Address: 9212 Empire Rock St  
City: Las Vegas State: NV Zip: 89143  
Telephone: (702) 533-8372  
E-mail address: Searchlightwest@aol.com  
Signature: Frederick C. Bauman

☐ Check here if this is a change of address.

RECEIVED BLM AZ STATE OFFICE 2012 AUG 31 A 10:34 PHOENIX, ARIZONA	BLM Date Stamp
--	----------------------

LINE NO.	AMC NUMBER	CLAIM/SITE NAME	COUNTY RECORDER DATA (If available)	TWP	RNG	SEC
1	413502	Grouler	BL 4865 Pg 137	10N	10W	26
2				10N	10W	35
3						
4						
5						
6						
7						
8						
9						
10						

List additional claims on Form MCF114.

**Bureau of Land Management**  
**Arizona State Office**  
[www.blm.gov/az/](http://www.blm.gov/az/)

No. of Claims: \_\_\_\_\_ x \$140 = \_\_\_\_\_  
Check No: \_\_\_\_\_ Init. \_\_\_\_\_  
Receipt No.: \_\_\_\_\_  
**For BLM Use Only**

**Form: MCF112**  
Revised July 2009

This form is available from the **Arizona Department of Mines and Mineral Resources** and may be reproduced.

# MAINTENANCE FEE PAYMENT

Claimant Name: Mineral Creek Resources Inc

Address: 121 E Birch Ave, Ste 508

City: Flagstaff State: AZ Zip: 86001

Telephone: 928 779 0166

E-mail address: goldresources@aol.com

Signature: [Signature]

☐ Check here if this is a change of address.

BLM  
Date  
Stamp

PHOENIX, ARIZONA

2012 AUG 31 A 10:35

RECEIVED  
BLM AZ STATE OFFICE

LINE NO.	AMC NUMBER	CLAIM/SITE NAME	COUNTY RECORDER DATA (If available)	TWP	RNG	SEC
1	411293	Ocotillo Grande	B-4838; P120	11N	1E	30
2	411292	Luz Marina	B-4838; P119	11N	1W	25
3	411288	Green Mohave	B-4838; P121	11N	1W	24
4	411289	Green Mohave 2	B-4838; P122	11N	1W	24
5	411290	Green Mohave 3	B-4838; P123	11N	1W	24
6	411291	Green Mohave 4	B-4838; P124	11N	1W	24
7	410574	Thunder Cloud #2	B-4832; P793	11N	1W	25
8	410575	Thunder Cloud #3	B-4832; P794	11N	1W	25
9	410576	Thunder Cloud #4	B-4832; P795	11N	1W	24
10	410577	Thunder Cloud #5	B-4832; P796	11N	1W	24

List additional claims on Form MCF114.

Bureau of Land Management  
Arizona State Office  
[www.blm.gov/az/](http://www.blm.gov/az/)

No. of Claims: \_\_\_\_\_ x \$140 = \_\_\_\_\_

Check No: \_\_\_\_\_ Init. \_\_\_\_\_

Receipt No.: \_\_\_\_\_

For BLM Use Only

Form: MCF112

Revised July 2009

This form is available from the Arizona Department of Mines and Mineral Resources and may be reproduced.

May be used with the following forms for listing additional mining claims:

- ☐ Affidavit of Performance of Annual Work
- ☒ Maintenance Fee Payment
- ☐ Notice of Intent to Hold Mining Claims
- ☐ Notice of Non-Liability for Labor and Materials Furnished

RECEIVED  
BLMAZ STATE OFFICE  
2012 AUG 31 A 10:33  
PHOENIX, ARIZONA

BLM  
Date  
Stamp

[illegible]

This form is available from the **Arizona Department of Mines & Mineral Resources** and may be reproduced.

United States Department of the Interior  
Bureau of Land Management  
LANDS/RECREATION & PLANNING  
ONE N CENTRAL AVE  
PHOENIX, AZ 85004 -2203  
Phone: 602-417-9200

Receipt

No:

2648525

Transaction #: 2729310

Date of Transaction: 09/04/2012

CUSTOMER:

MINERAL CREEK RESOURCES INC  
121 E BIRCH AVE STE 508  
FLAGSTAFF, AZ 86001-4621 US

LINE #	QTY	DESCRIPTION	REMARKS	UNIT PRICE	TOTAL
1	1.00	LOCATABLE MINERALS / MINING CLAIMS-NOT NEW-UNADJUD, ONE AUTH NO. ONLY / MINING CLAIM MONEY RECEIVED CASES: AMC396788/\$2380.00	MAINT 2013/17	- n/a -	2380.00
TOTAL:					\$2,380.00

PAYMENT INFORMATION			
1	AMOUNT:	560.00	POSTMARKED: N/A
	TYPE:	CHECK	RECEIVED: 09/04/2012
	CHECK NO:	1521	
	NAME:	MINERAL CREEK RESOURCES INC 121 E BIRCH AVE STE 508 FLAGSTAFF AZ 86001-4621 US	
2	AMOUNT:	1820.00	POSTMARKED: N/A
	TYPE:	CHECK	RECEIVED: 09/04/2012
	CHECK NO:	1522	
	NAME:	MINERAL CREEK RESOURCES INC 121 E BIRCH AVE STE 508 FLAGSTAFF AZ 86001-4621 US	

REMARKS

This receipt was generated by the automated BLM Collections and Billing System and is a paper representation of a portion of the official electronic record contained therein.

**NOTICE!!**

**These documents have been scanned!**

**Do not place un-scanned documents beneath this notice!**

**Do not remove this notice from this file!**

GPO Jacket No. 560-102  
Print Order 61540  
Rise Business Services, LLC  
Job=AZ15 5/15/2019



Box Number= AZ15052



Claim Begin-End: AMC413502-AMC413502

6 Location Notices-Amendments and Supporting Documents



AZ15052-7

AMC413297-AMC418724

# MINING CLAIM STATUS REPORT

DATA ENTERED JAN 30 2012 *pb*

MTP Checked by JAN 27 2012 *pb*

GEO Checked by JAN 27 2012 *pb*

LEAD SERIAL NUMBER AMC 413502 thru AMC 413502

## # OF CLAIMS & TYPE

# 1 LODE  
# \_\_\_\_\_ PLACER  
# \_\_\_\_\_ ASSOCIATION PLACER  
# \_\_\_\_\_ MILL SITE  
# \_\_\_\_\_ TUNNEL SITE

## CHARGES

Location Fee @ \$34 = \$ 34.00  
Processing Fee @ \$15 = \$ 15.00  
Maintenance Fee @ \$140 = \$ 140.00  
Overage (+) \$ \_\_\_\_\_  
Shortage (-) \$ \_\_\_\_\_  
Other Fees \$ \_\_\_\_\_

TOTAL \$ 189.00

## ARE THERE ENOUGH LOCATORS?

Yes ☒ No ☐

## DOCUMENTS RECEIVED VIA -

Over-the-Counter ☐ Mail ☒

## TIMELY FILED?

Yes ☒ No ☐

## LEGAL DESCRIPTION -

T 10N R 1W SEC 35, 26  
T \_\_\_\_\_ R \_\_\_\_\_ SEC \_\_\_\_\_  
T \_\_\_\_\_ R \_\_\_\_\_ SEC \_\_\_\_\_  
T \_\_\_\_\_ R \_\_\_\_\_ SEC \_\_\_\_\_

BLM ☐ FOREST SERVICE ☐ SUBJ TO PL 359: Yes ☐ No ☐

WILDERNESS AREA: No ☐ Yes ☐

SPLIT ESTATE - N/A ☐ SX ☐ PX ☐ SRHA ☐ OTHER ☐

Proper Notice Filed if Located on SHRA Lands? N/A ☐ Yes ☐ No ☐

## RECONVEYED MINERALS ON BLM LANDS REQUIRE OPENING ORDERS FROM 1944 TO 1993 -

Open to Entry on: \_\_\_\_\_ N/A ☐

COMMENTS/STATUS - VOID ☐ PARTIALLY VOID ☐ PVT MINERALS ☐ WITHDRAWN LANDS ☐

OTHER ☐

AMC 413502

Claimant acknowledges that portions of the following claims(s) site(s) may be void or voidable.

Printed Name of Claimant \_\_\_\_\_ Signature of Claimant \_\_\_\_\_

\*\*\*\*\* FINAL ADJUDICATION \*\*\*\*\*

DATE 6/11/2012 INITIALS TS

**United States Department of the Interior**  
**Bureau of Land Management**  
 LANDS/RECREATION & PLANNING  
 ONE N CENTRAL AVE  
 PHOENIX, AZ 85004 -2203  
 Phone: 602-417-9200

Receipt

No: 3136434

Transaction #: 3228492		ENTERED DEC 05 2014	
Date of Transaction: 09/25/2014		<i>Amendment placed on top (AC 635) PB</i>	
CUSTOMER:			
FREDERICK C BAUMAN		<i>of ORIGINAL LOCATOR Notice PB</i>	
6440 SKY POINTE DR STE 140-149			
LAS VEGAS, NV 89131-4047 US			

LINE #	QTY	DESCRIPTION	REMARKS	UNIT PRICE	TOTAL
1	1.00	LOCATABLE MINERALS / MINING CLAIMS- NOT NEW-UNADJUD, ONE AUTH NO. ONLY / MINING CLAIM MONEY RECEIVED CASES: AMC413502/\$10.00	AMENDMENT - 1	- n/a -	10.00
TOTAL:					\$10.00

PAYMENT INFORMATION			
1	AMOUNT:	10.00	POSTMARKED: N/A
	TYPE:	CHECK	RECEIVED: 09/24/2014
	CHECK NO:	1523	
	NAME:	SEARCHLIGHT EXPLORATION LLC 6440 SKY POINTE DR STE 140-149 LAS VEGAS NV 89131-4047 US	

REMARKS

This receipt was generated by the automated BLM Collections and Billing System and is a paper representation of a portion of the official electronic record contained therein.

Bauman  
6440 Sky Pointe Dr.,  
Ste 140-149  
Las Vegas, NV 89131



A202409 16 17575 1

FOREVER



PHOENIX, ARIZONA

2014 SEP 24 P 2:10

RECEIVED  
BLM AZ STATE OFFICE

BLM - Arizona State Office  
1 N. Central Ave, Ste 800  
Phoenix, AZ

Attn: Mining Claims

85004442700



85004

Bauman  
6440 Sky Pointe Dr.,  
Ste 140-149  
Las Vegas, NV 89131



A202409 16 17575 1

FOREVER



PHOENIX, ARIZONA

2014 SEP 24 P 2:10

RECEIVED  
BLM AZ STATE OFFICE

BLM - Arizona State Office  
1 N. Central Ave, Ste 800  
Phoenix, AZ

Attn: Mining Claims

85004442700



85004

When Recorded Return To:  
Frederick C. Bauman, Esq.  
6440 Sky Pointe Dr., Ste 140-412  
Las Vegas, NV 89131

2014-0040821  
09/08/2014 01:52:38 PM ANML  
Leslie M. Hoffman  
OFFICIAL RECORDS OF YAVAPAI COUNTY \$10.00  
CLARK COPPER MINES LLC

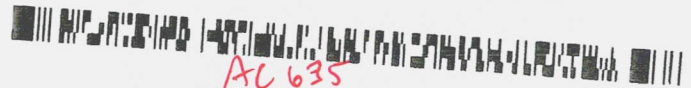

ENTERED DEC 05 2014

AC 635  
PB CORRECT LID

ORIGINAL AMENDMENT PLACED ON TOP  
OF ORIGINAL  
Location  
Notice  
PB

LOCATION NOTICE FOR **AMENDED LODE MINING CLAIM**

**NOTICE IS HEREBY GIVEN** that the amended **GROWLER** lode mining claim has been located by Clark Copper Mines, LLC, an Arizona limited liability company with a present mailing address of 6440 Sky Pointe Dr., Ste 140-412, Las Vegas, NV 89131. The claim was located on January 12, 2012 and recorded with the Yavapai County Recorder at Book 4857, page 885, and with the Arizona State Office of the BLM as **AMC413502** and was subsequently conveyed to Clark Copper Mines, LLC. The general course of the claim is north and south. It is situated in the Tiger Mining District, Yavapai County, Arizona. The claim is approximately 1,500 feet in length and 414 feet in width, and is irregular in shape due to conflict with neighboring patented mining claims. The end lines, however, are parallel and extra-lateral apex rights are claimed. This claim runs from the location monument on which this location notice is posted approximately 1,415 feet in a northerly direction to the north end line and 85 feet in a southerly direction to the south end line. This claim is marked by ten monuments, one at each corner and one at the center of each end line of the claim; there are also three additional monuments on the west side line of the claim, which are also the NE and NW corners of the Lookout patented mining claim, M.S. 2707 and the NW corner of the 2<sup>nd</sup> North Extension of the Grey Eagle patented mining claim, Lot No. 7. The Growler lode mining claim was previously located and is depicted on M.S. 4068, dated November 8, 1928. As this was a relocation, a monuments of the relocated claim are adopted as the monuments of this claim, except that in order to comply with subsequent changes in Arizona mining law, a new location monument has been erected on the claim's centerline at the No. 1 discovery cut and tunnel and new monuments have also been erected at the South Centerline and North Centerline of the claim.

This location notice is being amended to achieve conformity with M.S. 4068, a copy of which is attached hereto. The location monument on which this notice is posted is situated within Section 35, Township 10N, Range 1W, Gila and Salt River Base and Meridian, Arizona and this claim encompasses all or a portion of the following quarter section(s), Township(s) and Range(s): SW ¼ of Section 26 and NW ¼ of Section 35, T10N, R1W, Gila and Salt River Base and Meridian, Arizona. The locality of this claim with reference to some natural object or permanent monument and additional information (if any) concerning its locality are as follows: Claim is located as shown on M.S. 4068; by metes and bounds as follows:

Beginning at the northeast Corner No. 1., which bears N. 21 degrees 40 minutes E a distance of 4,867.8 feet to the N ¼ corner of Section 26, T10N, R1W, GSRB&M; thence S 6 degrees 41 minutes W a distance of 1,500 feet to the southeast Corner No. 2; thence N 87 degrees 56 minutes W a distance of 207.25 feet to the S Centerline; thence N 87 degrees 56 minutes W a distance of 207.25 feet to the southwest Corner No. 3; thence N 21 degrees 27 minutes E a distance of 994.15 feet to Corner No. 4; thence N 72 degrees W a distance of 9.8 feet to Corner No. 5; thence N 72 degrees 04 minutes W a distance of 99.7 feet to Corner No. 6; thence N 9 degrees E a distance of 532.1 feet to Corner No. 7; thence S 87 degrees 56 minutes E a distance of 122.95 feet to the N Centerline; thence S 87 degrees 56 minutes E a distance of 122.95 feet to Corner No. 1 and the place of beginning.

DATED AND POSTED on the ground this 4 day of September, 2014.

CLARK COPPER MINES, LLC

By Frederick C. Bauman  
Frederick C. Bauman  
Manager of Manager and Agent

RECEIVED  
CLARK COPPER MINES  
2014 SEP 24 P 2:10  
PHOENIX, ARIZONA

# **POOR QUALITY**

**The following pages are scanned at the best possible quality setting. The original pages are of poor quality and this is the best possible reproduction.**

SECS. 26 & 35, T10N, R1W

T10N, R1W

**MAP - Growler Claim**

**Name of Claim:** Growler lode

**Type of Claim:** Lode Claim

**Location Monument is located in:** Section 35,  
Township 10N, Range 1W, G&SRB&M, Yavapai  
County, Arizona

**Scale:** 1" = 200'

**The claim is located in:** Yavapai County, Arizona

**The type of corner and location monument used:**  
2" X 2" X 4' wooden post and stone

Def. 1/2" = 40' = 1"

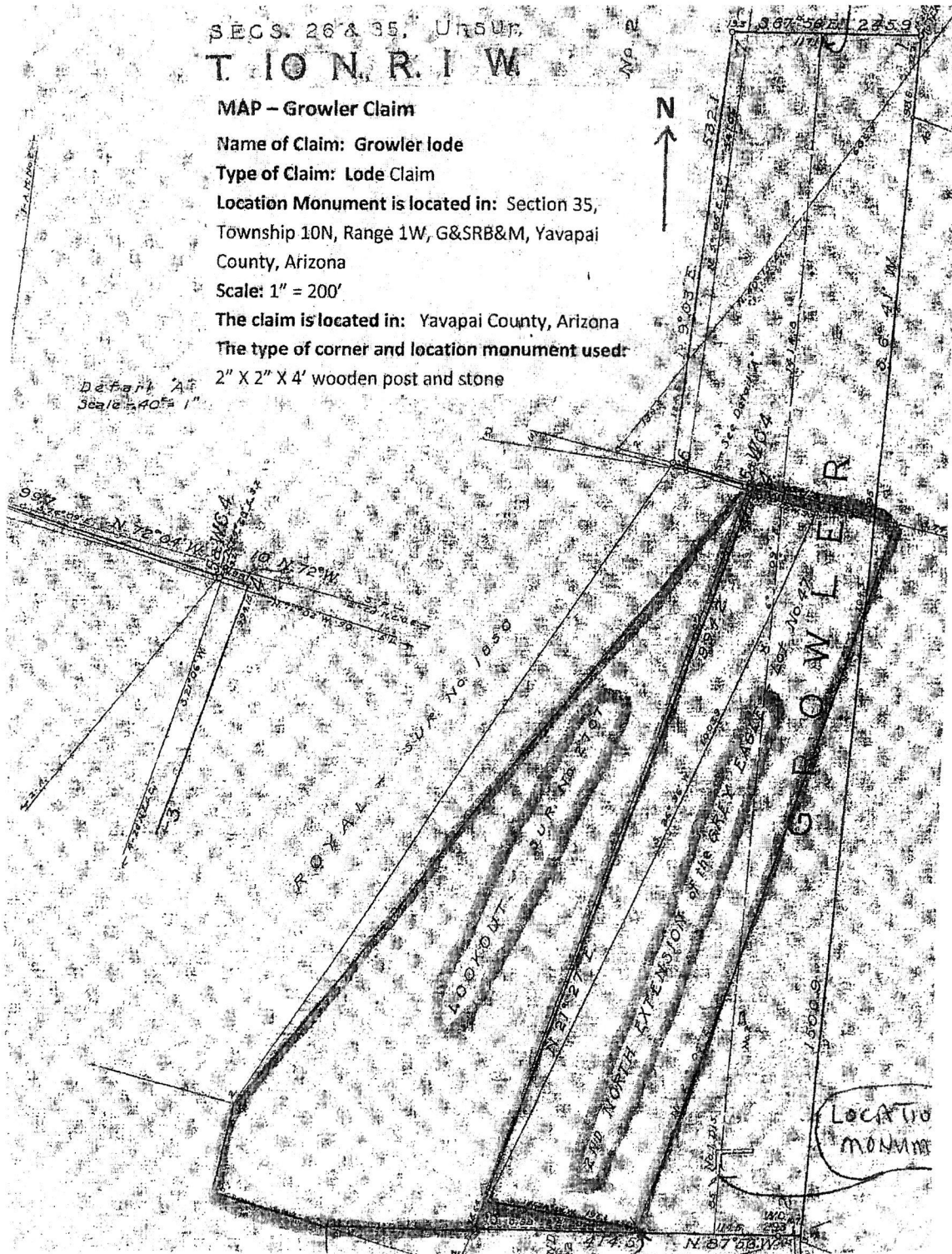

RECORDERS MEMO: LEGIBILITY  
QUESTIONABLE FOR GOOD REPRODUCTION

RECORDERS MEMO: LEGIBILITY  
QUESTIONABLE FOR GOOD REPRODUCTION

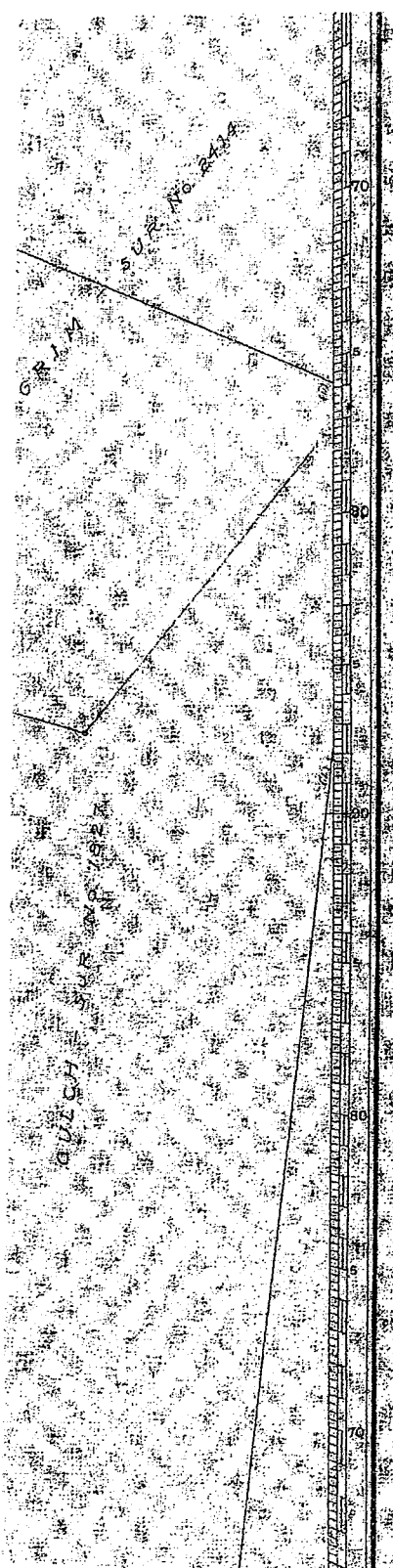

Mineral Survey No. **4068**

ARIZONA Land District

# PLAT

OF THE CLAIM OF  
H. D. ASKEW

KNOWN AS THE

GROWLER LOOP

IN Yavapai COCONINO MINING DISTRICT

Containing an Area of 9.143 Acres

Scale of 150 Feet to the inch

Surveyed April 4 & 12 1928 BY

William Naara

U.S. Mineral Surveyor

The Original Field Notes of the Survey of this Mining Claim from which this plat has been made under my direction have been examined and approved and are on file in this office and I hereby certify that they furnish such an accurate description of said Mining Claim as will be incorporated into a future series of maps to identify the property and that such references made thereon to natural objects or permanent improvements will be accurate and to the satisfaction of the Surveyor. I further certify that the Estimated Dollars worth of labor has been expended on improvements made upon or for the benefit of each location embraced in said mining claim by claimant

that said improvements consist of 2 cuts and 1 tunnel total value \$600.00

that the location of said improvements is correctly shown upon this plat and that no portion of said labor or improvements has been included in the estimate of expenditures upon any other claim.

and I further certify that this is a correct plat of said Mining Claim made in conformity with said original field notes of the survey thereof and the same is hereby approved.

Public Survey Office

Phoenix, Arizona

November 8, 1928

When Recorded Return To:  
Frederick C. Bauman, Esq.  
6440 Sky Pointe Dr., Ste 140-412  
Las Vegas, NV 89131

2014-0040821  
09/08/2014 01:52:38 PM ANML  
Leslie M. Hoffman  
OFFICIAL RECORDS OF YAVAPAI COUNTY \$10.00  
CLARK COPPER MINES LLC

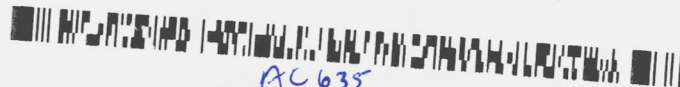

ENTERED DEC 05 2014

RC 635  
PD CORRECT LLD

### LOCATION NOTICE FOR AMENDED LODE MINING CLAIM

R#3136434

**NOTICE IS HEREBY GIVEN** that the amended **GROWLER** lode mining claim has been located by Clark Copper Mines, LLC, an Arizona limited liability company with a present mailing address of 6440 Sky Pointe Dr., Ste 140-412, Las Vegas, NV 89131. The claim was located on January 12, 2012 and recorded with the Yavapai County Recorder at Book 4857, page 885, and with the Arizona State Office of the BLM as AMC413502 and was subsequently conveyed to Clark Copper Mines, LLC. The general course of the claim is north and south. It is situated in the Tiger Mining District, Yavapai County, Arizona. The claim is approximately 1,500 feet in length and 414 feet in width, and is irregular in shape due to conflict with neighboring patented mining claims. The end lines, however, are parallel and extra-lateral apex rights are claimed. This claim runs from the location monument on which this location notice is posted approximately 1,415 feet in a northerly direction to the north end line and 85 feet in a southerly direction to the south end line. This claim is marked by ten monuments, one at each corner and one at the center of each end line of the claim; there are also three additional monuments on the west side line of the claim, which are also the NE and NW corners of the Lookout patented mining claim, M.S. 2707 and the NW corner of the 2<sup>nd</sup> North Extension of the Grey Eagle patented mining claim, Lot No. 7. The Growler lode mining claim was previously located and is depicted on M.S. 4068, dated November 8, 1928. As this was a relocation, a monuments of the relocated claim are adopted as the monuments of this claim, except that in order to comply with subsequent changes in Arizona mining law, a new location monument has been erected on the claim's centerline at the No. 1 discovery cut and tunnel and new monuments have also been erected at the South Centerline and North Centerline of the claim.

This location notice is being amended to achieve conformity with M.S. 4068, a copy of which is attached hereto. The location monument on which this notice is posted is situated within Section 35, Township 10N, Range 1W, Gila and Salt River Base and Meridian, Arizona and this claim encompasses all or a portion of the following quarter section(s), Township(s) and Range(s): SW 1/4 of Section 26 and NW 1/4 of Section 35, T10N, R1W, Gila and Salt River Base and Meridian, Arizona. The locality of this claim with reference to some natural object or permanent monument and additional information (if any) concerning its locality are as follows: Claim is located as shown on M.S. 4068; by metes and bounds as follows:

Beginning at the northeast Corner No. 1., which bears N. 21 degrees 40 minutes E a distance of 4,867.8 feet to the N 1/4 corner of Section 26, T10N, R1W, GSRB&M; thence S 6 degrees 41 minutes W a distance of 1,500 feet to the southeast Corner No. 2; thence N 87 degrees 56 minutes W a distance of 207.25 feet to the S Centerline; thence N 87 degrees 56 minutes W a distance of 207.25 feet to the southwest Corner No. 3; thence N 21 degrees 27 minutes E a distance of 994.15 feet to Corner No. 4; thence N 72 degrees W a distance of 9.8 feet to Corner No. 5; thence N 72 degrees 04 minutes W a distance of 99.7 feet to Corner No. 6; thence N 9 degrees E a distance of 532.1 feet to Corner No. 7; thence S 87 degrees 56 minutes E a distance of 122.95 feet to the N Centerline; thence S 87 degrees 56 minutes E a distance of 122.95 feet to Corner No. 1 and the place of beginning.

DATED AND POSTED on the ground this 4 day of September, 2014.

CLARK COPPER MINES, LLC

By Frederick C. Bauman

Frederick C. Bauman  
Manager of Manager and Agent

RECEIVED  
CLARK COPPER MINES, LLC  
2014 SEP 24 P 2:10  
PHOENIX, ARIZONA

SECS. 26 & 35, T10N, R1W

T10N, R1W

MAP - Growler Claim

Name of Claim: Growler lode

Type of Claim: Lode Claim

Location Monument is located in: Section 35,  
Township 10N, Range 1W, G&SRB&M, Yavapai  
County, Arizona

Scale: 1" = 200'

The claim is located in: Yavapai County, Arizona

The type of corner and location monument used:  
2" X 2" X 4' wooden post and stone

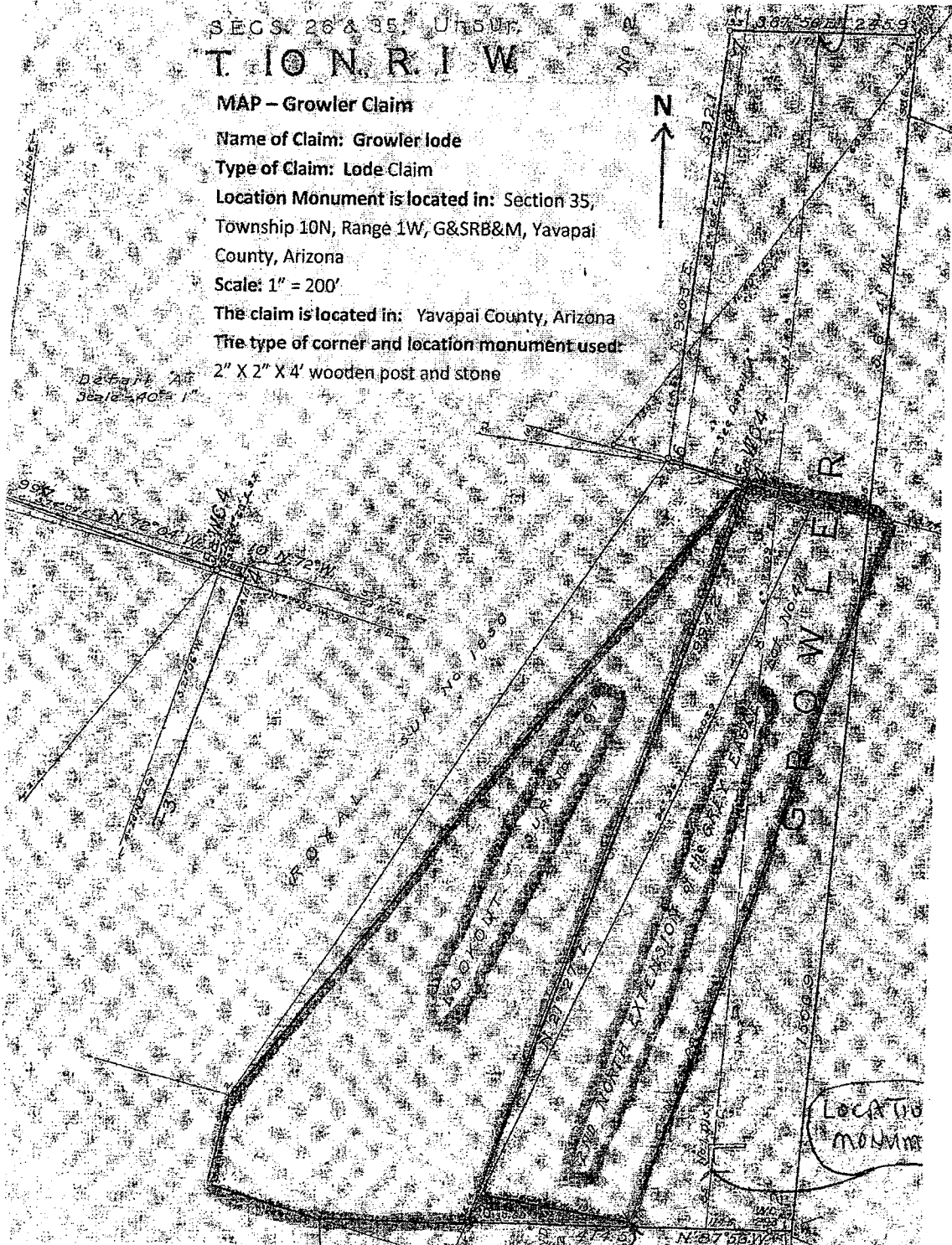

RECORDERS MEMO: LEGIBILITY  
QUESTIONABLE FOR GOOD REPRODUCTION

RECORDERS MEMO: LEGIBILITY  
QUESTIONABLE FOR GOOD REPRODUCTION

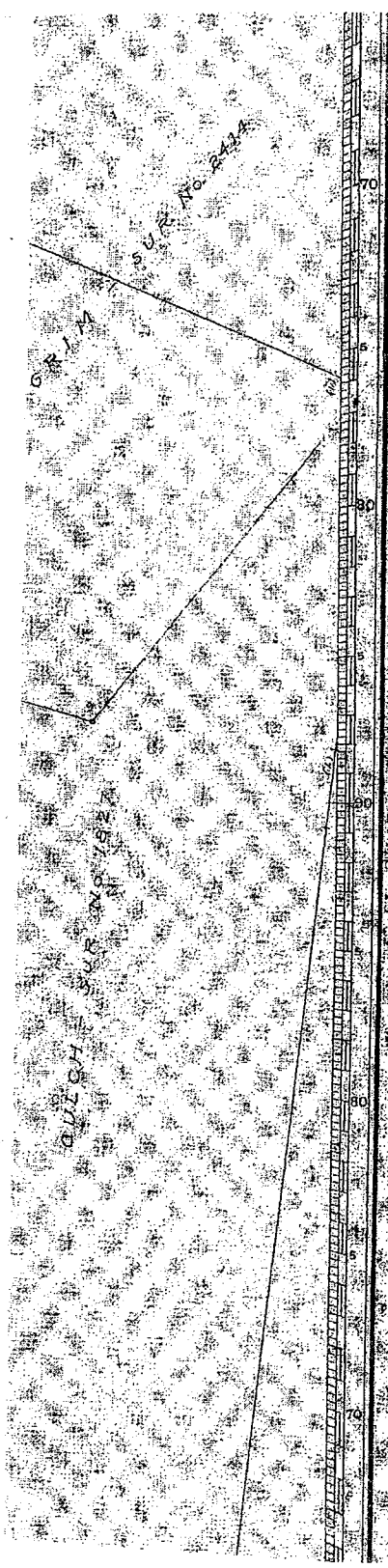

Mineral Survey No. **4068**

ARIZONA Land District

# PLAT

OF THE CLAIM OF

H. D. Atkin

KNOWN AS THE

GROWER LODGE

IN Tiger MINING DISTRICT

Yavapai COUNTY Arizona

Containing an Area of 9.443 Acres

Scale of 150 Feet to the inch

Variation 14 Feet

SURVEYED July 9 & 17 1928 BY

William Waaga

U.S. Mineral Surveyor

The Original Field Notes of the Survey of this Mining Claim from which this plat has been made under my direction have been examined and approved and are on file in this office and I hereby certify that they furnish an accurate description of said Mining Claim as well as incorporated into a platable survey fully to identify the premises and that such monuments made thereon to natural objects or permanent improvements will perpetuate and fix the location thereof.

I further certify that Five Hundred Dollars worth of labor has been expended on improvements made upon or for the benefit of each location situated in said mining claim by claimant.

Improvements and that said improvements consist of 2 shafts and 1 tunnel, total value \$500.00

that the location of said improvements is correctly shown upon this plat and that no portion of said labor or improvements has been included in the estimate of expenditures upon any other claim.

and I further certify that this is a correct plat of said Mining Claim made in conformity with said original field notes of the survey thereof and the same is hereby approved.

Public Survey Office

Phoenix, Arizona

Office Catalog Engineer

November 8 1928 Phoenix, Arizona

RECEIVED  
BLM  
2012 JAN 18 PM 1:11

# LOCATION NOTICE FOR LODE MINING CLAIM

NOTICE IS HEREBY GIVEN that the Growler Lode, MS 4068 lode mining claim has been located by Silver Nickel Mining Co. whose current mailing address is Tiger Mining District (Pine Grove Dist)  
5822 W. Michelle Drive, Glendale, Arizona 85308-1244

The general course of this claim is northerly and it is situated in YAVAPAI County, Arizona. irregular shaped claim due to conflict with patented claims.

This claim is 704.3 feet in length and 293 feet in width. This claim runs from the location monument on which this location notice is posted approximately 704.3 feet in a northerly direction to the north end line and 836.3 feet in a south direction to the south end line. This claim is marked by six monuments, one at each corner and one at the center of each end line of the claim. Claim WAS surveyed July 9-11, 1928 and known as the Growler Lode

The location monument on which this notice is posted is situated within Section 35 Township 10 N, Range 1 W, Gila Salt River Base and Meridian, Arizona and this claim encompasses portions of the following quarter section (s), section (s), Township (s) and Range (s)

SW 1/4 Sec 26, NW 1/4 Sec 35, T10N, R1W  
Gila Salt River Base and Meridian, Arizona. its east sideline is adjacent to Gulch, 1827 patented

The locality of this claim with reference to some natural object or permanent monument and additional information (if any) concerning its locality are as follows: The Growler's western sideline is adjacent to the 2nd North Ext of the Grey Eagle - Lot No 47, patented  
its southern end line is adjacent to the Cleveland north end line. Cleveland is MS 1722 patented

DATED AND POSTED on the ground this 12 day of JANUARY, 2012.

Cors. are wood posts set in mound of stones - see attached plat map of Mineral Survey No 4068. Scale of 150 feet to the inch. Bearings on plat. Distance shown on plat.

LOCATOR (s)

John B Rothornel for Silver Nickel Mining Co

Amended on  
9/24/2014  
To correct LLD  
PB

AMC 413502

SECS. 26 & 35. Unsub.  
T. 10 N. R. 1 W.

Scale  
150'

1"

ARIZONA MASCOT NO 2  
SUR NO 286.7

WINGWID SUR NO 24.4

W.C.4  
10 N 72° W  
M. 20.12

ROYAL SUR NO 1030  
Patented 1007.41 ft  
N 40° 35' E

LOOKOUT SUR NO 2707  
Patented  
N 21° 27' E

2ND NORTH EXTENSION of the GREY EAGLE -  
General No. 88  
Patented

CLEVELAND  
SUR NO 1722

GROWLER  
6000.51  
Patented

WIRE GOLD  
SUR NO 1027

RECEIVED  
BLM AT  
OFFICE  
2012 JUN 18 PM 1:16  
4281 ON HRS - H07700

AMC413502

\*owned by  
locator

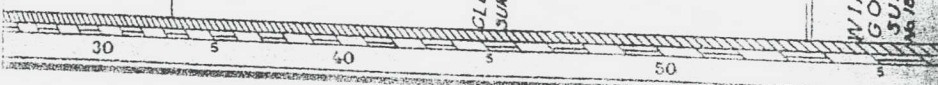

SILVER NICKEL MINING CO.  
5822 W. MICHELLE DRIVE  
GLENDALE, AZ 85308

PHOENIX AZ 850

17 JAN 12 PM 5:7



2012 JAN 18 PM 1:16

PHOENIX, ARIZONA

RECEIVED  
BLM AZ STATE OFFICE

bureau of land management  
arizona state office  
one north central avenue, suite 800  
phoenix, arizona 85004-4427

8500434427

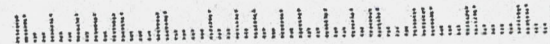

RUN TIME: 03:32 PM

Adm State: AZ

UNITED STATES DEPARTMENT OF INTERIOR  
BUREAU OF LAND MANAGEMENT  
GEOGRAPHIC REPORT WITH LAND  
Sorted by Meridian Township Range

RUN DATE: 01/27/2012  
Page 1 of 1

Serial Number: AZA 028558  
Total Case Acres: 25,517.000

<u>Casetype</u>	<u>Case Disp</u>	14	0100N	0010W	<u>Sect</u>	<u>Sur Typ</u>	<u>Sur Num</u>	<u>Suff</u>	<u>Subdivision</u>	<u>Act Pend</u>
232107	AUTHORIZED				026	ALIQ FF			E2NE,NESE; PART E2W2NE,NWSE,SESE;	

Serial Number: AZA 034574PT  
Total Case Acres: 1,717.980

<u>Casetype</u>	<u>Case Disp</u>	14	0100N	0010W	<u>Sect</u>	<u>Sur Typ</u>	<u>Sur Num</u>	<u>Suff</u>	<u>Subdivision</u>	<u>Act Pend</u>
220200	PENDING				035	FF			PART OF MS 2711;	

Serial Number: AZPHX 0086890  
Total Case Acres: 2.620

<u>Casetype</u>	<u>Case Disp</u>	14	0100N	0010W	<u>Sect</u>	<u>Sur Typ</u>	<u>Sur Num</u>	<u>Suff</u>	<u>Subdivision</u>	<u>Act Pend</u>
289100	AUTHORIZED				026	MS	1827	1		
						MS	1853	1		
						MS	1980	1		
						MS	2414	1		
						MS	267	1		
						MS	2863	1		
						MS	4068	1		
						MS	853	1		
						PROT		1	SW;	

RUN TIME: 03:32 PM

DEPARTMENT OF INTERIOR  
BUREAU OF LAND MANAGEMENT

RUN DATE: 01/27/2012  
Page 1 of 1

Input Parameters for Geographic Report with Land

System Id = CR

Admin State = AZ

Geo State = AZ

Casetype Begins With

Case Disp Txt = AUTHORIZED, CANCELLED, EXPIRED, PENDING, REJECTED, RELINQUISHED, WITHDRAWN

Mer Twp Rng =

Section =

Mtrs = 14 0100N 0010W 026, 14 0100N 0010W 035, 14 0100N 0010W 999

Commodity =

Commodity Txt =

Pending Org =

Pend Org Decode =

Total Rows Returned: 12

NO WARRANTY IS MADE BY BLM FOR USE OF THE DATA  
FOR PURPOSES NOT INTENDED BY BLM





SILVER NICKEL MINING CO.  
5822 W. MICHELLE DRIVE  
GLENDALE, AZ 85308

PHOENIX AZ 850

17 JAN 12 PM 5 T



PHOENIX, ARIZONA

2012 JAN 18 PM 1:16

RECEIVED  
BLM AZ STATE OFFICE

bureau of land management

arizona state office

one north central avenue, suite 800

phoenix, arizona 85004-4427

8500484427



Barrman  
9212 Empire Rock St  
Las Vegas, NV 89143

LAS VEGAS NV 890

16 MAR 2012 PM 3 1



US DOI / BLM  
1 N. Central Ave, Suite 800  
Phoenix, AZ

PHOENIX, ARIZONA

2012 MAR 19 PM 2:15

RECEIVED  
BLM AZ STATE OFFICE

Attn: Mining Claims

85004



Bauman  
10440 Sky Pointe Dr.,  
Ste 140-149  
Las Vegas, NV 89131

RECEIVED  
BLM AZ STATE OFFICE  
2013 AUG -7 AM 11:48  
PHOENIX, ARIZONA

LAS VEGAS NV 890

05 AUG 2013 PM 4 L



DOI/BLM  
Arizona State Office  
1 N Central Ave, Ste 800  
Phoenix, AZ

85004442700

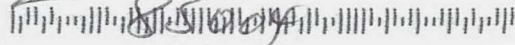

Attn: Mining Claims